

FALCON®

Door controls



SC80A Series



Medium-duty applications like retail storefronts, cafes and clinics that need a closer that makes door operation smooth and secure. The Falcon SC80A Series brings ANSI grade 1 durability and reliable performance to interior and exterior doors. An adjustable design ensures flexible installation and ADA compliance.

Standard features

- Single piece cast aluminum body
- Fully adjustable sizes 1-6
- Separate adjustable general speed, latch speed and backcheck
- Closer mounts hinge side, top jamb or parallel arm when either the RW/PA or HW/PA arm is specified
- Non-handed for left or right swinging doors
- 1 1/4" diameter heat treated steel piston
- Heat-treated pinion
- Universal screw pack for aluminum, hollow metal, and wood doors, includes self reaming, and tapping screws
- Staked valves
- Meets ANSI A117.1
- ANSI/BHMA A156.4, grade 1
- UL listed and compliant to UL10C and UBC 7-2 (1997)
- Cover is UL approved for use in fire rated assemblies
- 10-year warranty
- Retrofittable to Norton 8000 hole pattern

Listings and ratings

The Falcon SC81A is UL listed and compliant to UL10C and UBC 7-2 (1997). Additionally, the SC81A is designed to meet the American Disabilities Act (ADA) and ANSI A117.1. The SC81A is rated ANSI/BHMA A156.4, Grade 1.

SC80A Series hinge (pull side)

To 120°	11 3/4" - 298mm
121° to 180°	8 1/2" - 216mm

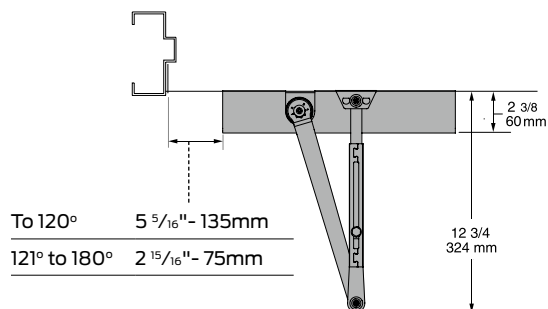
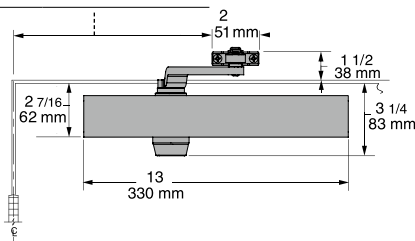

Butt hinges should not exceed 5" (127mm) in width.

Auxiliary stop is recommended at hold-open point or where a door cannot swing 180°

Reveal should not exceed 3/4" (19mm) for regular arm or hold-open arm.

Clearance of 2 3/8" (60mm) behind door required for 90° installation.

Delayed action add suffix "DEL" to selected cylinder (ex. SC80A DEL). Delays closing from maximum opening to approximately 70° with adjustable delay time.

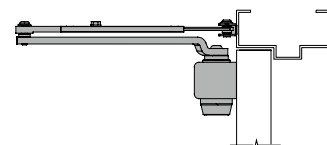

SC80A Series top jamb (push side)

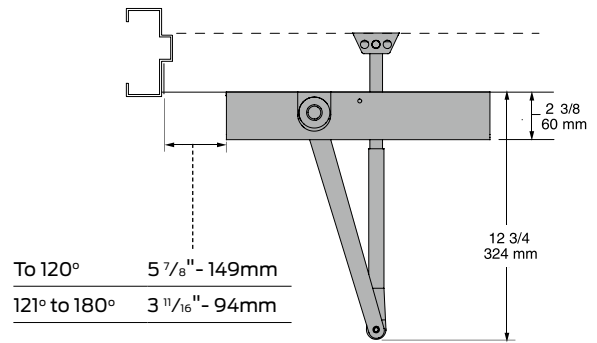
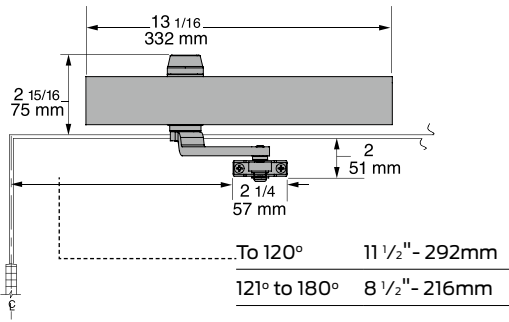

Butt hinges should not exceed 5" (127mm) in width.

Auxiliary stop is recommended at hold-open point or where a door cannot swing 180°.

Reveal should not exceed 3 1/4" (83mm) for regular arm or hold-open arm.

Head frame less than 2 5/16" (59mm) requires plate SC80A-18.

Delayed action add suffix "DEL" to selected cylinder (ex. SC80A DEL). Delays closing from maximum opening to approximately 70°, with adjustable delay time.

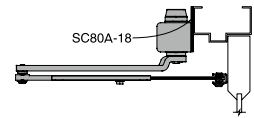
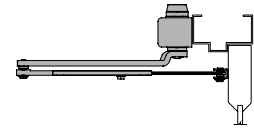

SC80A Series parallel (push side)

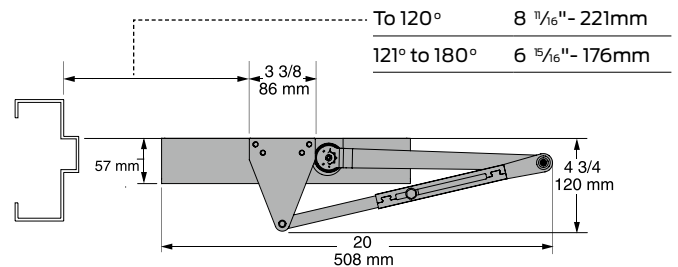
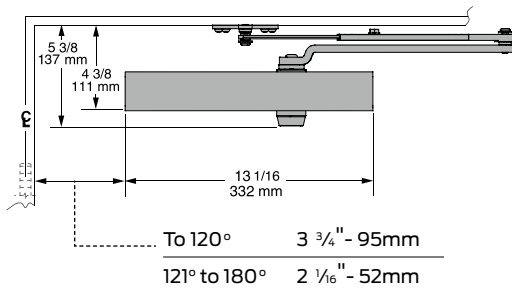

Butt hinges should not exceed 5" (127mm) in width.

Auxiliary stop is recommended at hold-open point or where a door cannot swing 180°.

Top rail less than 4 3/8" (111mm) measured from stop requires plate SC80A-18PA.

Delayed action add suffix "DEL" to selected cylinder (ex. SC80A DEL). Delays closing from maximum opening to approximately 70°, with adjustable delay time.

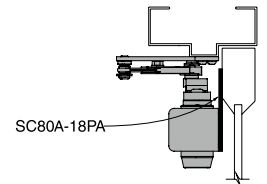
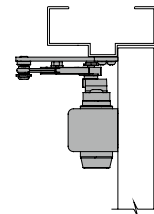

SC80A Series heavy duty (parallel)

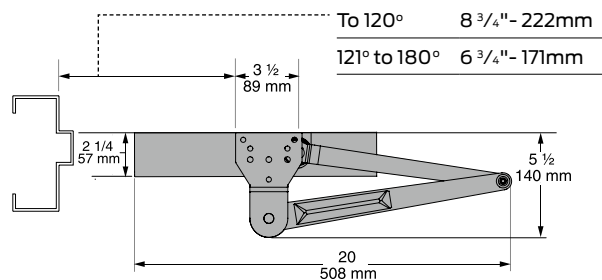
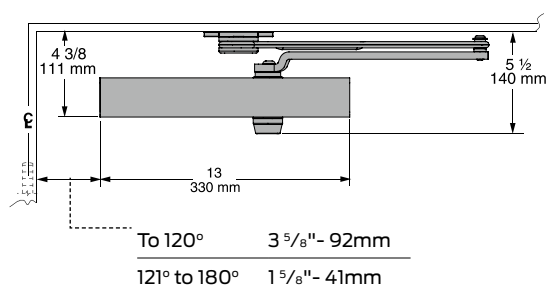

Butt hinges should not exceed 5" (127mm) in width.

Auxiliary stop is recommended at hold-open point, where a door cannot swing 180°, or where Dead stop or Spring-n-stop arm is not used.

Top rail less than 4 3/8" (111mm) measured from stop requires plate SC80A-18PA.

Delayed action add suffix "DEL" to selected cylinder (ex. SC80A DEL). Delays closing from maximum opening to approximately 70°, with adjustable delay time.

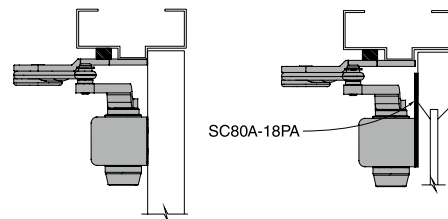

SC80A Series dead stop HO (parallel)

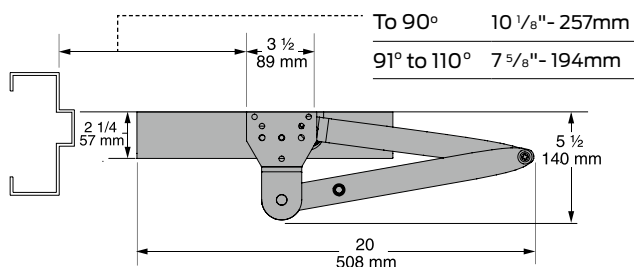
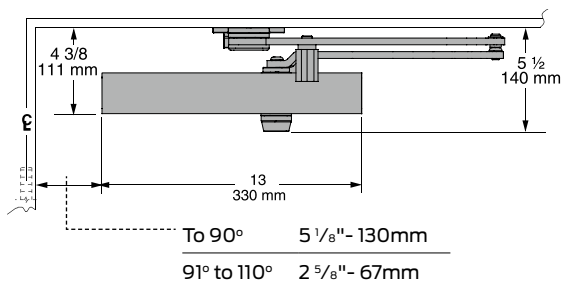

Butt hinges should not exceed 5" (127mm) in width.

Top rail less than 4 3/8" (111mm) measured from stop requires plate SC80A-18PA.

Delayed action add suffix "DEL" to selected cylinder (ex. SC80A DEL). Delays closing from maximum opening to approximately 70°, with adjustable delay time.

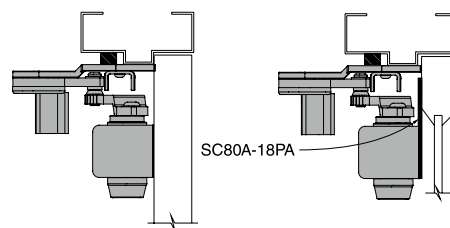

Arm types

All SC80A Series closers come with slim cover, standard arm and screw pack.

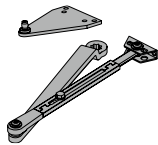

Regular arm, SC80A-3077PA
Non-handed arm with adjustable forearm assembly to accommodate a range of doors and frame reveal conditions. Mounts hinge side, top jamb or parallel arm. PA shoe included to allow installation in a parallel arm configuration.

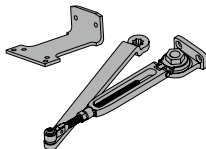

Hold-open regular arm, SC80A-3049PA
Optional, non-handed, hold open arm with adjustable forearm assembly to accommodate a range of doors and frame reveal conditions. Mounts hinge side, top jamb or parallel arm. PA shoe included to allow installation in a parallel arm configuration.

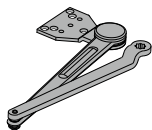

Heavy duty arm, SC80A-3077HD
Optional, non-handed, stamped, heavy duty, parallel arm for use in high-traffic applications.

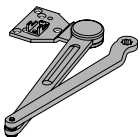

Dead stop arm, SC80A-3077DS
Optional, non-handed, stamped, heavy duty, parallel arm includes a positive mechanical stop and non-adjustable forearm assembly for high volume traffic or potentially abusive installation conditions.

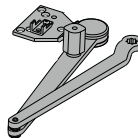

Dead stop hold-open Arm, SC80A-3049DS
Optional, non-handed, stamped, heavy duty, hold-open parallel arm includes a positive mechanical stop and non-adjustable forearm assembly for high volume traffic or potentially abusive installation conditions. Also includes a manually selective hold-open function.

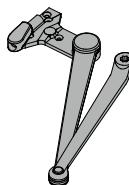

Spring-n-stop arm, SC80A-3077SS
Optional, non-handed, extra heavy-duty, forged parallel arm includes an integral spring stop and non-adjustable forearm assembly for high volume traffic or potentially abusive installation conditions.

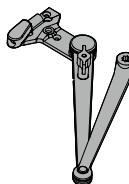

Spring-n-stop hold-open arm, SC80A-3049SS
Optional, non-handed, extra heavy-duty, forged parallel arm includes an integral spring stop and non-adjustable forearm assembly for high volume traffic or potentially abusive installation conditions. Also includes a manually selective hold-open function.

Installation accessories



Soffit shoe support, SC80A-30
Provides anchorage for fifth screw used with soffit shoe, where reveal is less than $3\frac{1}{16}$ " (78mm).

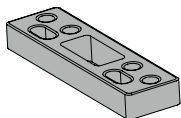

Blade stop spacer, SC80A-61
Required to lower parallel arm shoe to clear $\frac{1}{2}$ " (13mm) blade stop.

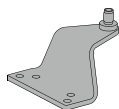

Auxiliary shoe, SC80A-62A
Requires a top rail of 7" (178mm). Optional shoe replaces PA shoe for parallel arm mounting of regular arm with overhead holder/stop.

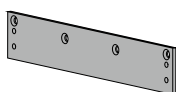

Plate, SC80A-18
Required for top jamb mounting where head frame is less than $1\frac{3}{4}$ " (44mm) or flush ceiling conditions exists.

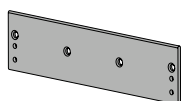

Plate, SC80A-18FC
Required for top jamb mounting where head frame is less than $1\frac{3}{4}$ " (44mm) or flush ceiling conditions exist. To be used with a full cover SC80A-72FC.

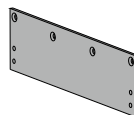

Plate, SC80A-18PA
Required for parallel arm mounting where top rail is less than $4\frac{3}{8}$ " (111mm), measured from the stop. Plate requires $1\frac{7}{8}$ " (48mm) minimum top rail measured from stop.

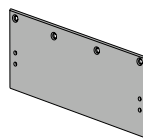

Plate, SC80A-18PAFC
Required for parallel arm mounting where top rail is less than $4\frac{3}{8}$ " (111mm), measured from the stop. Plate requires $1\frac{7}{8}$ " (48mm) minimum top rail measured from stop. To be used with a full cover SC80A-72FC.

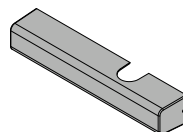

Cover, SC80A-72
Standard, non-handed, slim line plastic cover encloses the closer body with a cap on the unused pinion shaft.

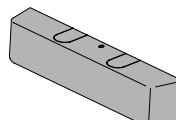

Cover, SC80A-72FC
Optional non-handed, full plastic cover encloses the closer body.

Cylinder options

Standard cylinder (STD) – Standard cylinder provides a main speed function to control the motion of the door from maximum opening angle until the door is a few inches from the latch where latch function controls the final closing motion. The opening swing is controlled by the hydraulic backcheck function from about 70° to maximum opening angle.

Delayed action cylinder (DEL) – Special cylinder provides a separate adjustable delayed closing motion from maximum opening angle to approximately 70°. Then the main speed function controls the door motion until the door is a few inches from the latch where latch function controls the final closing motion. During the opening swing the door is controlled by the hydraulic backcheck function from about 70° to maximum opening angle.

Competitive cross reference

Surface closer cross reference

Falcon	SC60A	SC70A	SC80A	SC90A
Norton	*1600BC	*7500/ 7700	*8500	1700BC
Hager	*5300	5100	*5200	5400
Stanley	*D-1650	D-4550	D-3550	
Yale	*50/ 51BC/1100	*4400	3300/ *3500	5100BC
Sargent	*1130	280/350	*1330	
Corbin		DC8000	DC3000	
Dorma	7400	8900	*8600	7300/ 7200

* identical footprint to listed Falcon closer.

Concealed closer cross reference

Falcon	OHC100 Series
Dorma	RTS88
Global	TC7000
International	Series 200, Series 300, Series 500
Jackson	20-330
Kawneer	Husky II
Sentinel	30 Series