



features

Yale is pleased to present the RL Series Tubular locks. This series is designed to work with *Yale Reflections*® levers. Engineered for ease of installation with the quality you expect from Yale, the RL Series will meet and exceed the expectations of the most demanding architects and design professionals. Ideal interior applications include hospitality, multi-use facilities, apartments and condominiums.

a.d.a.

The RL Series lever designs meet accessibility guidelines of the Americans with Disabilities Act and the requirements of the Uniform Federal Accessibility Standards and ANSI A117.1, all requiring ease of accessibility for the handicapped.

backset

RL Series Tubular locks are available with a 2-3/4" (70mm) standard. A 2-3/8" (60mm) optional backset available to order.

door thickness

Standard for doors 1-3/8" (35mm) to 1-3/4" (44mm). Optional door thickness 1-7/8" (48mm) to 2" (51mm) available to order (latchbolt centered in total door thickness).

fire listings

RL Series Tubular locks are available UL-cUL Listed for use on fire doors having a rating up to and including 3-hours. This option is available for RL201, RL202 and RL228 functions and can be ordered by suffixing "F" to the model number, i.e. RL201F.

handing

Handing should be specified. Locks can be easily field converted for installation on doors of either hand.

installation

RL Series Tubular locks conform to ANSI/BHMA specifications A156.115 which cover hardware preparations for steel doors and steel frames and A156.115-W which cover hardware preparations for wood doors with wood or steel frames.

latchbolts

Latchbolts brass with 1/2" (13mm) projection. 2-3/4" (70mm) backset furnished standard with square corner front, 2-1/4" x 1-1/8" (57mm x 29mm) faceplate. 2-3/8" (60mm) backset furnished standard with square corner front, 2-1/4" x 1" (57mm x 25mm) faceplate.

strikes

T-Strike 2-3/4" x 1-1/8" x 1-1/4" (70mm x 29mm x 32mm) lip to center supplied standard. Optional ANSI strike 4-7/8" x 1-1/4" x 1-1/4" (124mm x 32mm x 32mm) lip to center available to order.

warranty

RL Series Tubular locks carry a one-year warranty. Please see current *Yale Price Book* for detailed warranty information.

contents

- Introduction 2
- Features.....2
- Functions.....3
- Lever Designs 4-8
- Strikes9
- Latchbolts.....9
- Ordering Information..... 10
- Specifications 11

finishes

ANSI/BHMA Code	Finish Description	US Code
605	Bright Brass, Clear Coated	US3
606	Satin Brass, Clear Coated	US4
611	Bright Bronze, Clear Coated	US9
612	Satin Bronze, Clear Coated	US10
613	Dark Oxidized Satin Bronze, Oil Rubbed	US10B
N/A	Dark Oxidized Satin Bronze, Clear Coated*	US10BL
N/A	Statuary Dark Bronze, Clear Coated*	US20D
618	Bright Nickel Plated, Clear Coated	US14
619	Satin Nickel Plated, Clear Coated	US15
625	Bright Chrome Plated	US26
626	Satin Chrome Plated	US26D
629	Bright Stainless Steel	US32
630	Satin Stainless Steel	US32D

***Yale finishes are designated by ANSI/BHMA codes. There is no equivalent designation and requests will be processed by special order.**

rose options

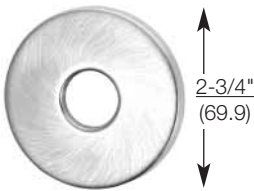
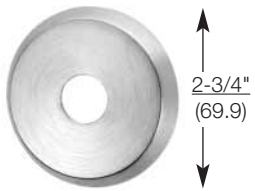
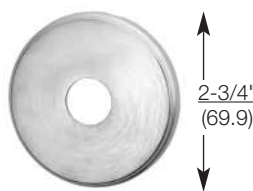
R3	R4	R5
		
$\frac{2-3}{4}$ " (69.9)	$\frac{2-3}{4}$ " (69.9)	$\frac{2-3}{4}$ " (69.9)

strikes

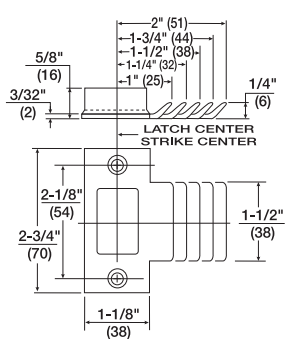
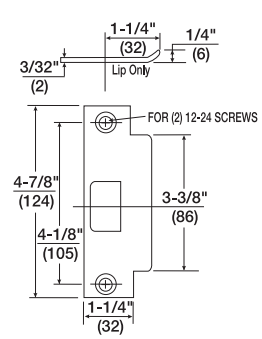
 <p>Standard Strike Model No. 371 x 1-1/4" lip supplied standard with RL Series locks. This strike will accommodate frames for 1-3/8" to 1-3/4" thick doors. Strikes with other lip dimensions shown are available to special order. All Model No. 371 strikes are supplied with wrought strike box Part No. 14-5301-1033.</p>	 <p>Optional 497 ANSI Strike For doors and frames with ANSI/BHMA A156.115 preparations. 1-1/4" supplied standard. 1-18", 1-1/2" and 1-3/4" lip lengths available by special order.</p>
---	---

latchbolts

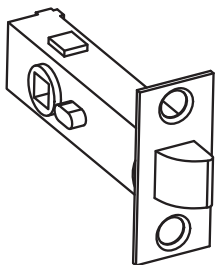

Model Number	Backset	Description
RLP34	2-3/4"	Square Corner Front (Standard) 2-1/4" x 1-1/8" faceplate
RLP38	2-3/8"	Square Corner Front 2-1/4" x 1" faceplate

specification

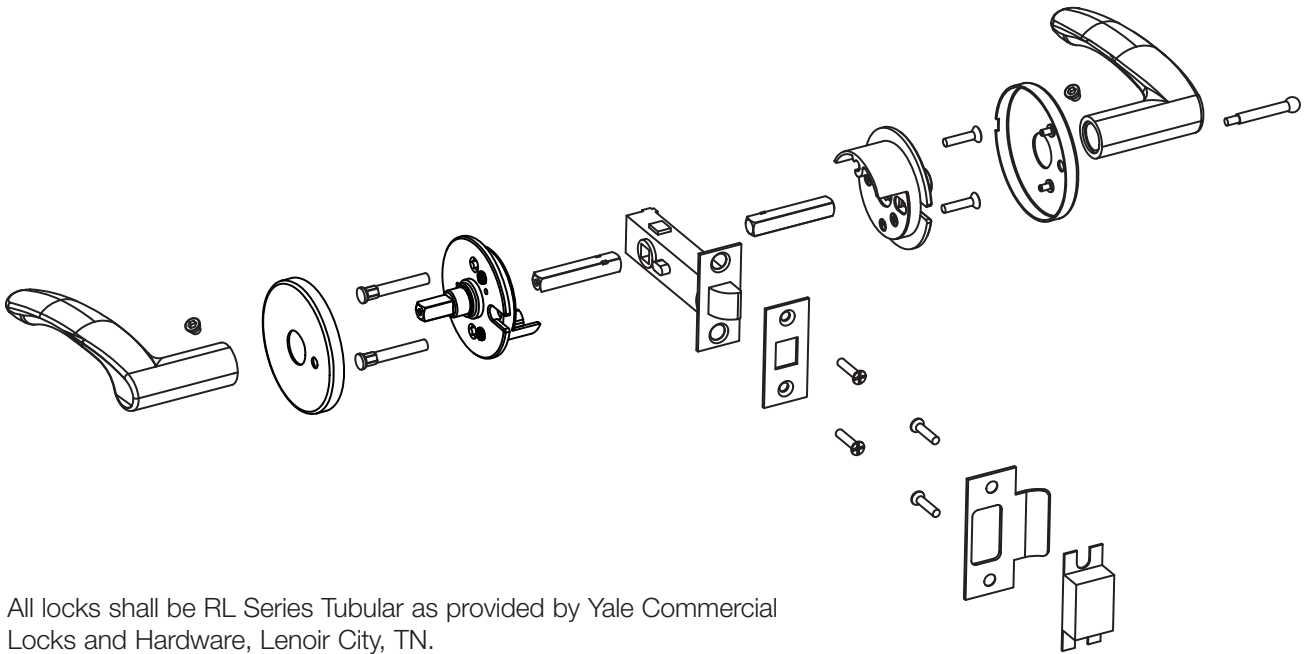

All locks shall be RL Series Tubular as provided by Yale Commercial Locks and Hardware, Lenoir City, TN.

Locks shall have an interlocking tubular chassis and latchbolt. Chassis mounting screws shall be accessible only when the levers and roses are removed.

All locks shall mount in a standard ANSI/BHMA 161 door prep (2-1/8" diameter) without additional thru-bolt preps.

All locks and latchbolts shall be non-handed and reversible for ease of installation.

All locks shall have bi-directional lever operation and lever handles shall be a minimum of 4-1/4" (108 mm) in length. All levers shall be made of solid material with no plastic fillers.

All locks shall be adjustable for 1-3/8" (35mm) and 1-3/4" (44mm) door thickness.

All locks shall have a standard 2-3/4" (70mm) backset and offered with optional 2-3/8" (60mm) backset.

All latchbolts shall have a 1/2" (13mm) throw.

All strikes shall be non-handed with a curved lip.

Certification:

ANSI A117.1 Accessibility Code
UL 3-hour Rating (Optional)

All locks shall carry a one-year warranty.