

INSTALLATION

3590 Multi-Lock Connector

for use with External Reader Antennas or
an External Power Supply



This versatile connector kit, 3590-CKT is required when an external reader antenna is used with multiple locks or an external reader.

The Multi-Lock connector allows the use of the external power supply along with external reader antennas. When using external power supply, remove battery from all locks.

With the connector, multiple locks can be connected together allowing all locks to be unlocked at the same time. The Group feature of the locks must be enabled from the factory.

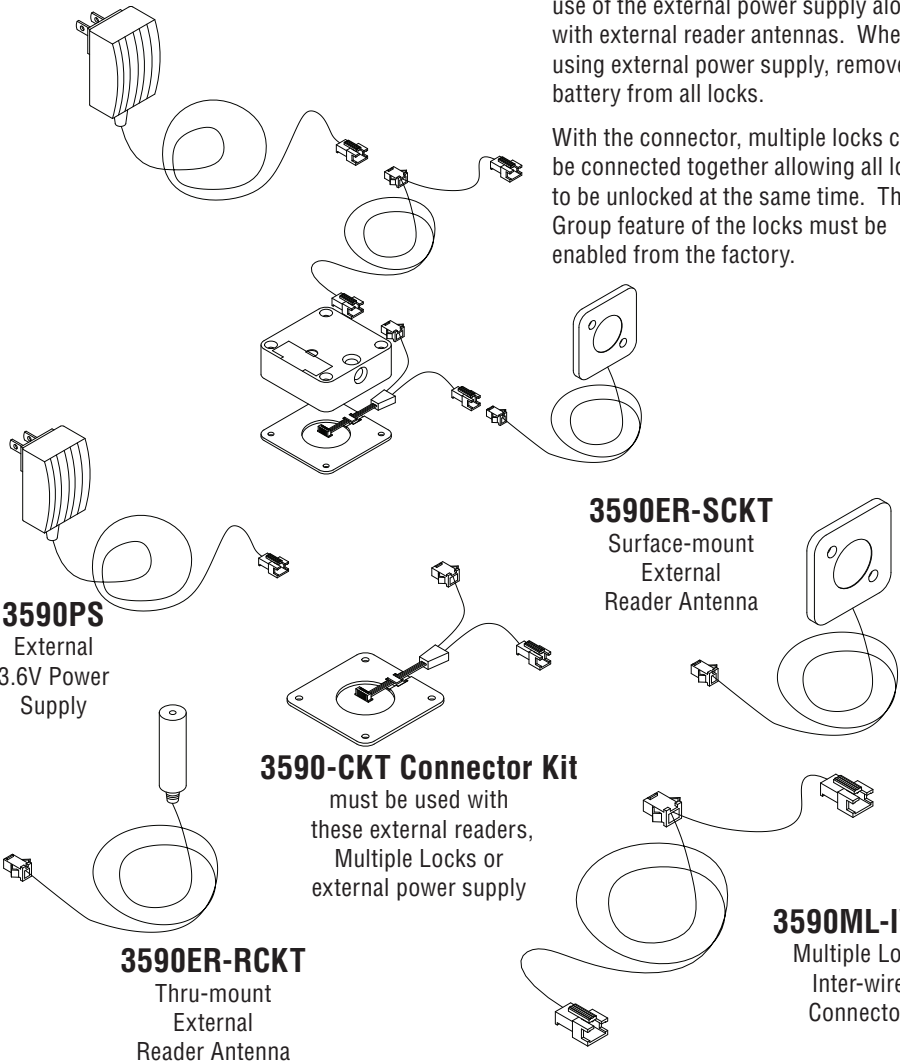

3590PS
External
3.6V Power
Supply

3590ER-SCKT
Surface-mount
External
Reader Antenna

3590-CKT Connector Kit
must be used with
these external readers,
Multiple Locks or
external power supply

3590ER-RCKT
Thru-mount
External
Reader Antenna

3590ML-IWC
Multiple Lock
Inter-wire
Connector