

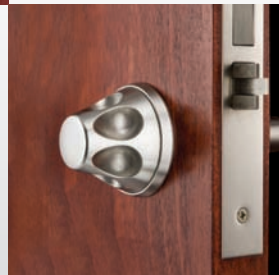

Specialty Hardware

Product Catalog

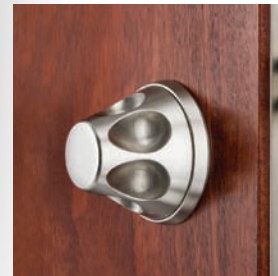

Features/Functions

HP3000 Series Tubular Lock with Push/Pull Paddle Trim

The HP3000 Series tubular Lock with push/pull paddle trim provides an aesthetically pleasing alternative to products with standard push/pull trim. Its heavy-duty design and ANSI/BHMA Grade1 strength help it to withstand abuse from rigorous environments. Multiple mounting orientations, hands free operation and a sleek, aesthetic form, make the HP3000 Series ideal for use in healthcare facilities and educational facilities.

Features

Handing

Passage (HP3010) function is non-handed.
Privacy (HP3020) function is handed.
Specify hand.

Door Thickness

1-3/4" (44mm) standard.
Optional door thicknesses available; see Quick Codes, page 15.

Backset

5" (127mm) standard.
Optional: 2-3/4" (70mm) and 7" (177mm); see Quick Codes, page 15.

Latchbolt

Brass, 1/2" (13mm) throw

Strike

ANSI curved lip strike standard, 4-7/8" x 1-1/4" x 1-1/4" lip to center. Optional strikes, lip lengths and ANSI wrought strike box available; See Quick Codes, page 16.

Covers

Cast stainless steel

Paddles

Cast stainless steel

Mounting Options

Paddle trim can be mounted as horizontal (up or down) and vertical (sideways) orientations in the field.

Cover and Paddle Dimensions

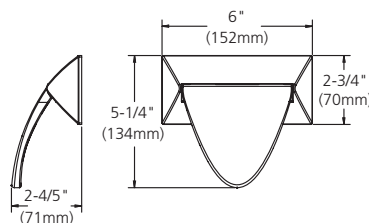

Warranty

One-year limited



Patent pending and/or patent
www.assaabloydss.com/patents

Certification/Compliance

ANSI/BHMA

Certified A156.2 Series 4000
Grade 1.



UL-cUL

Listed for use on 3 hour fire doors (4' x 8' single and smaller doors). UL symbol on front stamped letter F indicates listing.

Any retrofit or other field modification to a fire rated opening can potentially impact the fire rating of the opening, and Corbin Russwin, Inc. makes no representations or warranties concerning what such impact may be in any specific situation. When retrofitting any portion of an existing fire-rated opening, or specifying and installing a new fire-rated opening, please consult with a code specialist or local code official (Authority Having Jurisdiction) to ensure compliance with all applicable codes and ratings.

ADA

Meets A117.1 Accessibility Code.

Functions

Series/Function	Type	Function Description
HP3010	Passage	<ul style="list-style-type: none"> Both paddles retract latch Ideal for patient rooms and closets
HP3020	Privacy	<ul style="list-style-type: none"> Inside paddle always retracts latch Outside paddle retracts latch, except when locked by inside push button Closing door unlocks outside paddle Includes emergency release Vertical orientation required Ideal for bathrooms

Quick Codes

Cylinder and Keying

Description	Specify
Conventional 6-pin	(standard)
Conventional 7-pin	7P
Less cylinder(s)	LC
IC 6-pin	C6
IC 6-pin with temporary construction core	
Red	CT6R
Blue	CT6B
Green	CT6G
IC 6-pin less core	CL6
SFIC 6-pin with SFIC disposable temporary core	CT6SD
SFIC 6-pin with Less Core ¹	CLS6
IC 7-pin	C7
IC 7-pin with temporary construction core	
Red	CT7R
Blue	CT7B
Green	CT7G
IC 7-pin less core	CL7
SFIC 7-pin with SFIC disposable temporary core	CT7SD
SFIC 7-pin with Less Core ¹	CLS7
Security	HS
Security IC	CHS
Access 3® Patented Fixed Core	AP
Access 3® Security Fixed Core	AS
Access 3® High Security Fixed Core	AHS
Access 3® Patented IC	ACP
Access 3® Security IC	ACS
Access 3® High Security IC	ACHS
Pyramid High Security Fixed Core	PHS
Pyramid High Security IC	PCHS
Pyramid IC Less Core	CLP
Pyramid with temporary construction core	CTP
Pyramid Security	PS
Pyramid Security IC	PCS
Pyramid Disposable Core	CTPD
6-Pin Disposable Core	CT6D
7-Pin Disposable Core	CT7D
Keyed random	KR
Construction master keyed (not available for Pyramid)	CMK

Cylinder and Keying (cont.)

Description	Specify
Visual key control	
- No keying data stamped on key or cylinder	VKC0
- Keys only	VKC1
- Cylinders and keys (not for HS, CHS, PHS or PCHS)	VKC2
- Cylinders only (not for HS, CHS, PHS or PCHS)	VKC3
Concealed key control (CKC)	
- CKC cylinders with VKC keys	CKC2
- CKC cylinders only (not for PHS or PCHS)	CKC3
2 keys per lock	(standard)
More than 2 keys	KY# (e.g., KY6)

1. Not available with ML2029.

Finishes

Description	Specify
ANSI/BHMA 630 (US32D)	Satin Stainless Steel 630
630C	Satin Stainless Steel with MicroShield®  630C

Door Thickness

Door Thickness	Specify
1-3/4" (44mm)	(standard)
2" (51mm)	D200
2-1/4" (57mm)	D214

ML2000 or ML20900 x HPSK available 1-3/4" door thickness only.

Backset - HP3000 Series (5" - Standard)

Description	Specify
5" (127mm)	(standard)
2-3/4" (70mm)	B234
7" (177mm)	B700

Quick Codes

Strikes - Mortise

ANSI Lip to Center	ANSI Straight Lip Specify	Curved Lip Specify
1-1/8" (29mm)	(standard)	SA118
1-1/4" (32mm)	SS114	SA114
1-3/8" (35mm)	SS138	SA138
1-1/2" (38mm)	SS112	SA112
1-3/4" (44mm)	SS134	SA134
2" (51mm)	SS200	SA200
2-1/4" (57mm)	SS214	SA214
2-1/2" (64mm)	SS212	SA212
2-3/4" (70mm)	SS234	SA234
3" (76mm)	SS300	SA300

Strikes - Tubular

Lip to Center	ANSI Curved Lip, Specify	Curved Lip Box, Specify	Full Lip, Specify
1" (25mm)	SA100	SC100	N/A
1-1/8" (29mm)	SA118	SC118	N/A
1-1/4" (32mm)	(standard)	SC114	SF114*
1-3/8" (35mm)	SA138	SC138	N/A
1-1/2" (38mm)	SA112	SC112	N/A
1-3/4" (44mm)	SA134	SC134	N/A
2" (51mm)	SA200	SC200	N/A
2-1/4" (57mm)	SA214	SC214	N/A
2-1/2" (58mm)	SA212	SC212	N/A
2-3/4" (70mm)	SA234	SC234	N/A
3" (76mm)	SA300	SC300	N/A

*Specify SFR114 for rounded corner.

Handing

Description	Specify
Right Hand	RH
Left Hand	LH
Right Hand Reverse	RHR
Left Hand Reverse	LHR

Miscellaneous Options

Description	Specify
Spanner head screws	M02
Phillips head screws	(standard)
Torx® head screws	M04
Hex head screws (HP3000)	M05
Latch front, rounded corners (HP3000)	M13
ANSI wrought strike box	M17
Lead lining (HP3000)	M28
Lead lining (BHSS, BLSS, HSS, HPSK)	M29
Half trim (for ML2010, ML2020, ML2022, ML2024, ML2029, ML2030, ML2032, ML2052, ML2053, ML2055, ML2056, ML2057, ML2058, ML2059, ML2062, ML2065) (Supplied with inside trim only. Includes cylinder) ¹	M30
Working trim only ²	M31
"PUSH & PULL" Identification ³ (HPSK, HP3000)	M38
Tapered Cylinder Collar ¹	M111
Latch hold back (for ML2042, ML2052, ML2055, ML2051, ML2057 only) ⁴	LHB

1. Available on HPSK trim only

2. HSS must be ordered complete with lockbody from the factory. HPSK trim only available for lockbody manufactured after January 2017. BLSS trim only available for lockbody manufactured after July 2008

3. Non-handed

4. Must use A02 cam when LHB is specified