

FALCON®

Medium
duty

Commercial pushpads



Table of contents

1490 Concealed vertical rod touchbar	4
1590 Rim touchbar	5
1690 Concealed vertical rod touchbar	6
1790 Rim touchbar	7
19-R Series	8
F-19-R Series	9
19-V Series	10
F-19-V Series	11
Trim designs	12
Trim chart	13
Type and functions	14
Door applications	16
Strikes	17
Power supply	18
Accessories	19
How to order	21

The Falcon difference

Safety, security and uncompromising value

At Falcon, we know that every product you sell not only has to meet local building codes, but also your expectations for performance and quality. We take your expectations seriously, and that's why we build our exits to deliver durability, convenience and unmatched value. After all, we've built our reputation on the same standards that you have – providing quality products at a reasonable price delivered on time. It's the way we do business and it's what makes Falcon exits a powerful choice no matter what your project.



1490 Concealed vertical rod touchbar device

The 1490 offers a clean appearance with pushpad styling and a variety of practical features. The 1490 is built with rugged steel operating mechanisms, and durable aluminum push bars and end caps.



Length	Minimum door size (non-EL)	Minimum door size (EL)
36"	25 3/4"	34 3/4"
42"	25 3/4"	34 3/4"
48"	36 3/4"	43 3/4"

Consult factory for special sizes.



Specifications

Hand:	Specify RHR or LHR-supplied RHR if not specified.
Functions:	See trim selection chart on this page.
Finishes:	US28, DC13, DC 35, US3, US9, US10, US4, US10B, US14, US15.
Strikes:	PB48 top.
Latches:	RL - Rod bottom latch (standard), Hex bottom latch (standard for EL), PL - Pullman bottom latch (optional), ES - electric strike top latch (optional). Device needs to be less bottom rod (LBR).
Dogging feature:	Quarter turn hex dogging standard. No threaded parts to wear out.
Cylinder:	Rim, night latch (NL) or hold back (HB) feature available. Simplified cartridge mounting for most standard rim cylinders. Furnished in DC35 if not specified.
Sizes:	36", 42", 48".
Doors:	1 3/4" thick metal doors-specify if other than 1 3/4".*
Projections:	2 3/4" maximum, 2" when dogged. Pushbar height is 3".
Stile:	1 3/4" minimum.
Electric functions:	EL - electric latch retraction, include "S". Requires PS914-2RS minimum power supply. S- latch bolt monitor switch (SPDT). Conversion kits available. Devices are handed.
Fasteners:	All mounting screws are concealed. Uses all machine screws for device and latch.
End caps:	Durable zinc die cast, powder coated.
Vertical rods:	1' standard, extension rods available up to 7' 10".
ANSI:	Certified ANSI A156.3 2001 Grade 1 standards.
Shim kits:	1/2" riser is available.
Hurricane:	1490 devices are used for hurricane rated door openings. Consult door manufacturer's listing.

Model	Trim package	Type	Function
1490	No outside trim	6	01
1491	Pull only (9970)	6	02
1492	NL cylinder	6	03
1493	HB cylinder	6	04
1494	Pull (9970) w/ NL cylinder	6	02/03
1495	Pull (9970) w/ HB cylinder	6	02/04
1498	Dummy	6	

* 9970 is for use on HM and Alum doors only. Not for use on wood doors.

1590 Rim touchbar device

The 1590 offers the clean looks and easy pushpad design of the 1490 with the installation and maintenance ease of a rim exit device.



Length	Minimum door size (non-EL)	Minimum door size (EL)
36"	25"	35"
42"	25"	35"
48"	36"	43"

Consult factory for special sizes.

Model	Trim package	Type	Function
1590	No outside trim	6	01
1591	Pull only (9970)	6	02
1592	NL cylinder	6	03
1593	HB cylinder	6	04
1594	Pull (9970) w/ NL cylinder	6	02/03
1595	Pull (9970) w/ HB cylinder	6	02/04

Specifications

Hand:	Non handed, "push" labels for each hand supplied standard.
Functions:	See trim selection chart on this page.
Finishes:	US28, DC13, DC35, US3, US9, US10, US4, US10B, US14, US15.
Strikes:	TD35 strike supplied standard. STK45 optional.
Latchbolt:	1 1/4" high x 3/4" projection, hardened steel.
Dogging feature:	Quarter turn hex key dogging.
Cylinder:	Night latch (NL) or hold back (HB) feature available, simplified cartridge mounting for most standard rim cylinders, furnished in DC35 if not specified.
Sizes:	36", 42", 48".
Doors:	1 3/4" thick metal or wood, specify if other than 1 3/4".*
Projections:	2 3/4" maximum, 2" when dogged. Pushbar height is 3".
Stile:	2" minimum.
Electric functions:	EL - electric latch retraction, include "S". Requires PS914-2RS minimum power supply. S - latch bolt monitor switch (SPDT). Conversion kits available. Devices are handed.
Fasteners:	All mounting screws are concealed.
Endcaps:	Durable zinc die cast, powder coated.
ANSI:	Certified ANSI A156.3-2001 Grade 1 standards.
Shim kits:	1/2" riser is available.
Retractors:	Used for cylinder assembly, special retractors available for use with mullions.
Mullions:	Removable mullions are available for pairs of doors, see page 19.

* 9970 is for use on HM and Alum doors only. Not for use on wood doors.

1690 Concealed vertical rod touchbar device

The design of the 1690 is ideal for demanding, moderate-traffic applications. The vertical rods and latch mechanisms are concealed in the vertical door stile, ensuring trouble-free operation. Cast metal cover plates and end caps hold up to rigorous use. A quick, single-point dogging feature in the housing deactivates the device, permitting unrestricted traffic flow. The 1690 may also be used to retrofit a 1990 Series crossbar device.



Length	Minimum door size (non-EL)	Minimum door size (EL)
30"	24"	28 1/2"
36"	30"	34 1/2"
42"	36"	40 1/2"
48"	42"	46 1/2"



Positioning retractor as shown for NL or HB functions.

Install retractor as shown below for both RHR and LHR doors; this makes all keys function in the same direction.

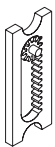

Hold back (HB)

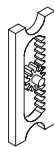

Night latch (NL)

Specifications

Hand:	Field reversible, non-handed.
Functions:	See trim selection chart on this page.
Finishes:	US28, DC13, DC 35, US3, US10, US26, US26D. Centercase and end cap are powder-coated black only.
Strikes:	PB48 top.
Latches:	Standard top - SU latch. Standard bottom - hex bottom bolt. Optional top - ES - electric strike top latch, device must be less bottom rod (LBR). Optional bottom - RL - rod bottom latch. - PL - pullman bottom latch.
Dogging feature:	Hex key dogging standard, except EL where must use hold back feature on outside cylinder.
Cylinder:	Rim, night latch (NL) or hold back (HB) feature available. Field selectable.
Sizes:	30", 36", 42", and 48".
Doors:	1 3/4" thick metal doors, specify if other.*
Projections:	3 3/8" in neutral position, 2 3/8" in dogged position. Pushbar height is 2 1/2".
Stile:	1 3/4" minimum.
Electric functions:	EL - electric latch retraction, ED - electric dogging (both EL and ED require PS914-2RS minimum power supply). RX - request to exit switch, monitors pushpad SPTD switch.
Fasteners:	All machine screw mounting. Device mounting fasteners are concealed, latch fasteners are exposed to egress side.
End caps:	Black powder-coated metal end caps.
Vertical rods:	7' standard, extension rods available up to 10'. Rod extension kits available.
ANSI:	Certified ANSI A156.3 grade 1 standards.
Hurricane:	1690 devices are used for hurricane rated door openings. Consult door manufacturer's listing.

Model	Trim package	Type	Function
1690	No outside trim	6	01
1691	Pull only (9970)	6	02
1692	Cylinder only	6	03/04
1694	Pull and cylinder	6	02/03/04

* 9970 is for use on HM and Alum doors only. Not for use on wood doors.

1790 Rim touchbar device

The 1790 rim device is typically used in applications where maintenance is a concern because the rim device has fewer parts and pieces than current exit devices. The result is less maintenance and adjustment. The streamlined design has no openings for chains, reducing the risk for code infringements and offering increased building security by eliminating the possibility of tampering and forced entry through the use of coat hangers and other tools. The 1790 may also be used to retrofit a 2090 series crossbar device.



Length	Minimum door size (non-EL)	Minimum door size (EL)
30"	24"	28 1/2"
36"	30"	34 1/2"
42"	36"	40 1/2"
48"	42"	46 1/2"

- Lock/unlock capability
- ADA accessible
- Lever designs
 - Dane
 - Sutro
 - Quantum

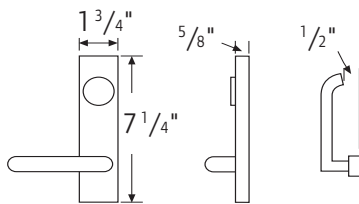

Lever projection: Quantum = 3"
 Sutro = 2 7/8"
 Dane = 2 7/8"

Key locks or unlocks trim. Lever retracts latchbolt when trim is unlocked. Dane, Quantum and Sutro levers return to within 1/2" of door.

Specifications

Hand:	Non handed.
Functions:	See trim selection chart on this page.
Finishes:	US28, DC13, DC35, US3, US10, US26, US26D. Centercase and end cap are powder-coated black only.
Strikes:	TD35 strike supplied standard, see page 11 for other rim strikes available.
Latchbolt:	1" thickness, 3/4" throw.
Dogging feature:	Hex key dogging standard, except EL where must use hold back feature on outside cylinder.
Cylinder:	Rim, night latch (NL) or hold back (HB) available (field selectable).
Sizes:	30", 36", 42", and 48".
Doors:	1 3/4" thick metal or wood, specify if wood door.**
Projections:	3 3/8" in neutral position, 2 3/8" in dogged position. Pushbar height is 2 1/2".
Stile:	1 3/4" minimum.
Electric functions:	EL - electric latch retraction, ED - electric dogging (both EL and ED require PS914-2RS minimum power supply). RX - request to exit switch, monitors pushpad SPTD switch.
Fasteners:	All machine screw mounting. Device mounting fasteners are concealed, latch fasteners are exposed to egress side.
End caps:	Black powder-coated metal end caps.
ANSI:	Carry UL label and approved for life safety. Certified ANSI A156.3 grade 1 standards.
Mullions:	Removable mullions are available for pairs of doors, see page 19.

Model	Trim package	Type	Function
1790	No outside trim	4	01
1791	Pull only (9970)	4	02
1792	Cylinder only	4	03/04* or 08/09*
1794	Pull (9970) and cylinder	4	02/03/04

* Requires use of 179L

**9970 is for use on HM and Alum doors only. Not for use on wood doors.

19-R Series non-handed rim device

Panic exit hardware

The Falcon 19-R Series rim device that delivers superior panic hardware with modern touchbar styling.

This non-handed device covers a 161 cutout and may be used on 1 3/4" narrow stile aluminum doors.

The "EO" (exit only) device is ready to accept any trim function shown on page 12.

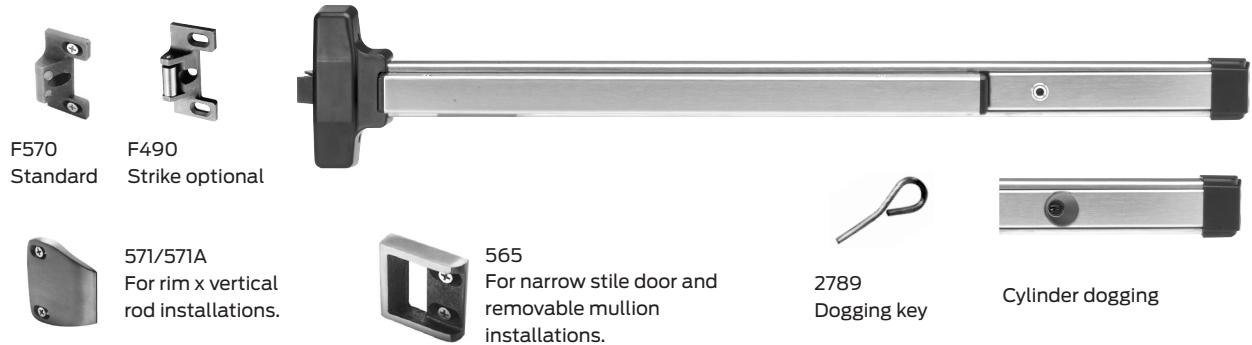

Device & trim	ANSI type	ANSI function
19-R-EO	1 or 4	01
19-R-DT	1 or 4	02
19-R-NL	1 or 4	03
19-R-K (or L or KIL)	1 or 4	08
19-R-K-NL (or L-NL or kil-nl)	1 or 4	09
19-R-TP-BE	1 or 4	
19-R-K-BE	1 or 4	
19-R-K-DT	1 or 4	
19-R-L-BE	1 or 4	
19-R-L-DT	1 or 4	
19-R-KIL-BE	1 or 4	
19-R-KIL-DT	1 or 4	

Note: For blank escutcheon specify BE.

Specifications

Hand:	Non-handed.
Functions:	See trim selection chart on this page.
Finishes:	SP28, SP313, US32D. Centercase and end cap are powder-coated black only.
Strikes:	Standard - F570. Optional - F490, 565, 571, 571A.
Latch:	Stainless steel, 3/4" throw dead locking.
Dogging feature:	Hex key dogging standard. Cylinder dogging or less dogging optional.
Sizes:	3' for doors from 2'5" up to 3'. 4' for doors from 3' up to 4'.
Doors:	1 3/4" thick metal or wood doors, specify if other.
Projections:	2 1/2" in neutral position, 1 7/8" in dogged position. Pushbar height is 1 3/4".
Stile:	1 3/4" minimum.
Fasteners:	All machine screw mounting. Device mounting fasteners are concealed, latch fasteners are exposed to egress side.
End caps:	Black plastic end caps.
ANSI:	Certified ANSI A156.3 grade 1 standards.

F-19-R Series non-handed rim device

Fire exit hardware

The F-19 Rim fire exit device is an excellent addition to the touchbar. This device is non-handed and is listed by UL for B label fire door installations on 4'0" x 7'2" single doors and/or 8'0" x 7'2" double doors with an F-4023 removable mullion or KRF-4023. The "EO" (exit only) device is ready to accept any trim function shown on page 12.



F570
Standard



F490
Strike optional



Device & trim	ANSI type	ANSI function
F-19-R-EO	1 or 4	01
F-19-R-NL	1 or 4	03
F-19-R-K (or L or KIL)	1 or 4	08
F-19-R-K-NL (or L-NL or KIL-NL)	1 or 4	09

Note: For blank escutcheon specify BE

Specifications

UL:	"B" label (1 1/2" hr.); 4'0" x 7'2".
Functions:	All functions built into "EO" device. All 19 series trim works with rim or vertical devices. See trim selection chart on pages 15 and 16.
Finishes:	Power-coated aluminum-SP28; power-coated duranodic-SP313; stainless steel US-32D.
Strikes:	Stainless steel, F570 or F490.
Latchbolt:	Stainless steel, 3/4" throw.
Deadlocking latchbolt:	Standard.
Sizes:	3' for doors from 2'5" up to 3'. 4' for doors from 3' up to 4'.
Doors:	1 3/4" thick wood or metal. Specify thickness if other than 1 3/4". (SNB must be specific on wood or composite doors.)
Projections:	2 1/2" in neutral position, 1 7/8" in depressed position. Pushbar height is 1 3/4".
Sex bolts:	When used with wood, composite or non-reinforced hollow metal, sex bolts must be specific, 3-#4122 (1/4"-20)SNB standard. An additional 2-#2729 (10-24) SNB must be specified.
ANSI:	Certified ANSI A156.3-2001 grade 1 standards.
Shim kit:	For glass lite applications; 1/4" thick specify SK 19-R-1/4".
161 Cutout:	Device covers 161 cutout with KIL and Centron trims. Other trim requires cover plate.



19-V Series non-handed vertical rod device

Panic exit hardware

Manufactured to the same standards as the 19 Rim, the 19-V exit device complies with most exit door requirements, and is fully reversible and surface applied. This device is regularly furnished with deadlocking top latch with latch retention and square bolt at bottom. The "EO" (exit only) device is ready to accept any trim function shown on page 12.

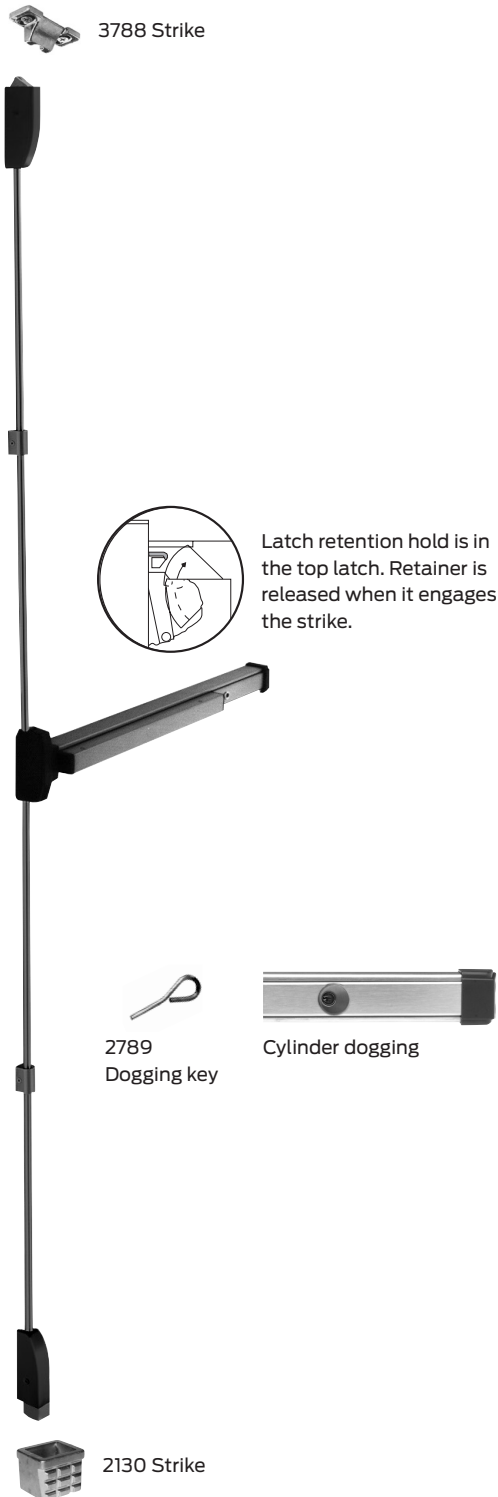

Device & trim	ANSI type	ANSI function
19-V-EO	2 or 5	01
19-V-DT	2 or 5	02
19-V-NL	2 or 5	03
19-V-K (or L)	2 or 5	08
19-V-K-NL (or KIL)	2 or 5	09

Note: For blank escutcheon specify BE.

Specifications

Hand:	Field reversible.
Functions:	All functions built into "EO" device. All 19 Series trim works with rim or vertical devices. See Trim Selection Chart on pages 15 and 16.
Finishes:	Powder-coated aluminum-SP28; powder-coated duranodic-SP313; stainless steel US-32D.
Strikes:	3788 strike is surface applied standard, 2130 strike is mortised into floor.
Angle bracket:	Use 4215 angle bracket in flush transom or rabbeted installations. Allows use of standard 3788 strike.
Latchbolt:	Top stainless steel $\frac{3}{4}$ " throw. Bottom square bolt $\frac{1}{2}$ " throw.
Deadlocking latchbolt:	Standard.
Dogging feature:	Half turn hex dogging standard. No threaded parts to wear out.
Cylinder dogging:	Specify "CD" prefix. Use $1\frac{1}{8}$ " long mortise cylinder with standard "A" cam.
Stock sizes:	3' for doors from 2'5" up to 3'. 4' for doors from 3' up to 4'.
Doors:	$1\frac{3}{4}$ " thick, wood or metal. Specify thickness if other than $1\frac{3}{4}$ ".
Narrow stile doors:	To $1\frac{3}{4}$ " N.S. aluminum. With control trim- $2\frac{1}{4}$ " min. stile.
Projection:	$2\frac{1}{2}$ " max., $1\frac{7}{8}$ " dogged.
Fasteners:	All mounting screws are concealed. Furnished with sheet metal screws. Machine screws available, specify AMS.
Sex bolts:	3-#4122 ($\frac{1}{4}$ "-20) SNB standard. Hollow core wood, light gauge hollow metal, etc. require additional sex bolts. 19-V: 6-#2729 #10-24 SNB; 19-V-LBR: 3-#2729 #10-24 SNB
ANSI:	Certified ANSI A156.3 2001 grade 1 standards.
19-V:	Latch retention and 3788 strike top, deadbolt and 2130 flush strike bottom.
19-V-LBR:	3788 strike top.
Vertical rods:	Furnished to length based on $40\frac{5}{16}$ " horizontal CL from finished floor and a 7'0" door standard. Variations from these standards must be specified when ordering.
Shim kit:	For glass lites applications; $\frac{1}{4}$ " thick specify SK-19-V- $\frac{1}{4}$ ".
161 cutout:	Device covers 161 cutout with KIK/KIL and Centron trims. Other trim requires cover plate.

F-19-V Series non-handed vertical rod device

🔥 Fire exit hardware

Manufactured to the same standards as the F-19 Rim, the F-19-V 🔥 Fire exit device complies with most exit door requirements, and is fully reversible and surface applied. This device is regularly furnished with deadlocking top latch retention and square bolt at bottom. (This device is listed by UL for “B” label fire door installations.) The “EO” (exit only) device is ready to accept any trim function shown on page 12.

3788
Strike

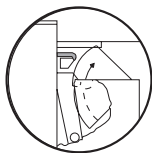
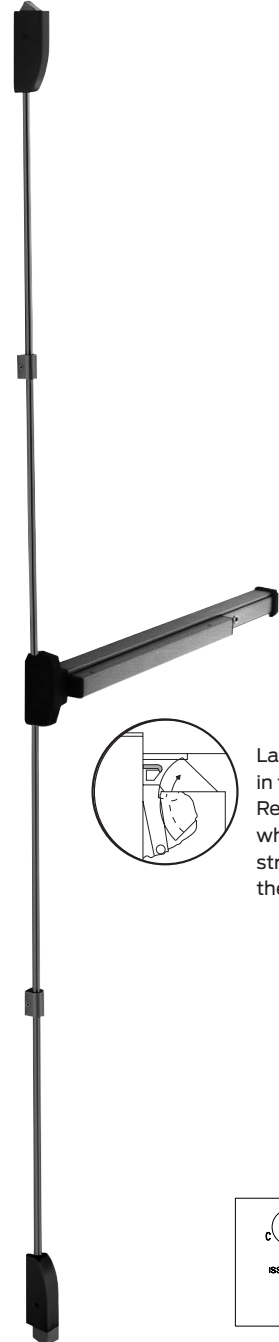

Latch retention hold is in the top latch. Retainer is released when it engages the strike. The door is in the closed position.



2130
Strike

Device & trim	ANSI type	ANSI function
F-19-V-EO	2 or 5	01
F-19-V-DT	2 or 5	02
F-19-V-NL	2 or 5	03
F-19-V-K (or L or KIL)	2 or 5	08
F-19-V-K-NL (or L-NL or KIL-NL)	2 or 5	09

Note: For blank escutcheon specify BE.

Specifications

Hand:	Field reversible.
Functions:	All functions built into “EO” device. All 19 Series trim works with rim or vertical devices. See Trim Selection Chart on pages 15 and 16.
Finishes:	Powder-coated aluminum—SP28; powder-coated duranodic—SP313; stainless steel US-32D.
Strikes:	3788 strike is surface applied. 2130 strike is mortised into floor.
Latchbolt:	Top stainless steel 3/4" throw. Bottom square bolt 1/2" throw.
Deadlocking latchbolt:	Standard.
Stock sizes:	3' for doors from 2'5" up to 3'. 4' for doors from 3' up to 4'.
Doors:	1 3/4" thick, wood or metal. Specify if other than 1 3/4" thick.
Projection:	2 1/2" maximum.
Fasteners:	All mounting screws are concealed. All machine screws standard.
Sex bolts:	3— #4122 (1/4"-20) SNB standard. Composite or non-reinforced wood, hollow metal require additional sex bolts. F-19-V: 6— #2729 #10-24 SNB; F-19-V-LBR: 3— #2729 #10-24 SNB.
ANSI:	Certified ANSI A156.3-2001 grade 1 standards.
F-19-V:	Latch retention and 3788 strike top deadbolt and 2130 flush strike bottom.
F-19-V-LBR:	Latch retention and 3788 strike top.
Vertical rods:	Furnished to length based on a 40 5/16" horizontal CL from finished floor and a 7'0" door standard. Variations from these standards must be specified when ordering.
Shim kit:	For glass lites applications; 1/4" thick specify SK-19-V-1/4".
161 cutout:	Device covers 161 cutout with KIK/KIL and Centron trims. Other trim requires cover plate.

Trim designs

Control trim

SP28, SP313 and US-32D.

K-control



911K
BE
NL

L-control



L-Control-Dane
912L
BE
L-DT
NL



L-Control-Sutro
912L
BE
L-DT
NL



L-Control-Quantum
912L
BE
L-DT
NL

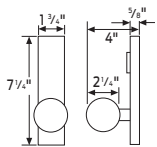

Key locks or unlocks trim. Knob retracts trim. Knob retracts latchbolt when trim is unlocked.

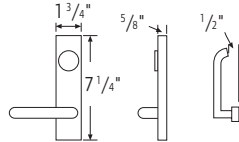

Lever Projection: Quantum = 3"
Sutro = 2 7/8"
Dane = 2 7/8"

Key locks or unlocks trim. Lever retracts latchbolt when trim is unlocked. Dane, Quantum and Sutro levers return to within 1/2" of door.

DT-control



918 DT
Pull when dogged.

NL-control



918NL
Key retracts latchbolt.

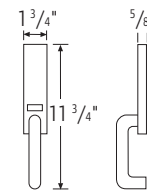

9970
Can be used with all devices (not for use on wood doors).

9 1/4" center to center

2 7/8" projection

1 3/4" clearance

Cover plates



4167
3 1/4" x 15" x .050
Used with TP control & DT control
Covers 161 & 86 cutouts



4168
3 1/4" x 7 1/2" x .050
Used with EO device to cover No. 86 cutout for mortise lock



4170
3 1/4" x 7 1/2" x .050
Used with K control, DT/K control, L control, or DT/L control
Covers 161 & 86 cutouts

Key-in-lever



914KIL



914-KIL-IC

For 1-3/4" thick doors only

Centron trim

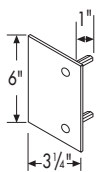

930 EO

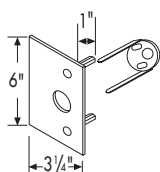

930 C

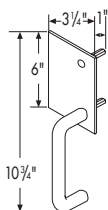

930 DT

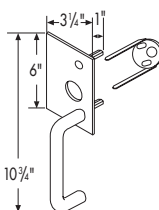

930 NL



Pull only 917 DT
CTC - 5 1/2" round - 3/4" dia.
Pull when dogged.

Trident trim

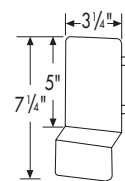

920 DT

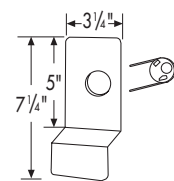

920 NL

Trim chart

Control

Device	DT	NL	T-BE	K	K-BE	K-DT
19-R/19-V	918	918	910	911	911	911
Cylinder type	—	rim	—	1 1/8" Mortise	—	—

Device	Dane*			Sutro*			Quantum*					
	L	L-BE	L-DT	L	L-BE	L-DT	L	L-BE	L-DT	L	L-BE	L-DT
19-R/19-V	912	912	912	912	912	912	912	912	912	912	912	912
Cylinder type	1 1/8" Mortise	—	—	1 1/8" Mortise	—	—	1 1/8" Mortise	—	—	1 1/8" Mortise	—	—

KIL

Device	KIL*	KIL-LS/LK'	KIL-NL*	KIL-IC*
19-R/19-V	914	914	914	914
	Falcon "C" keyway A23160	—	Falcon "C" keyway A23160	Small format

Trident trim

Device	Trident trim		Centron		
	NL	DT	C	DT	NL
19-R/19-V	920	920	930	930	930
Cylinder type	Rim	—	Rim	—	Rim

* Specify hand.

Note: For "NL" night latch function on K and L add "NL" after trim number.
All locking trim except KIL furnished less cylinder.

Type and functions

These pages list all functions available for the 19 Series devices.

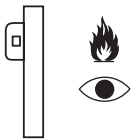
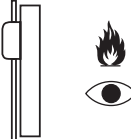
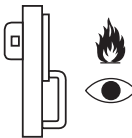
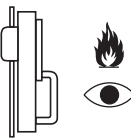
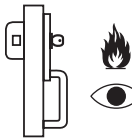
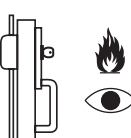
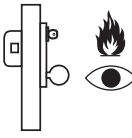
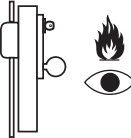
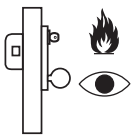
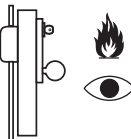
	Rim devices ANSI type 1 and 4.	Vertical rod devices ANSI type 2 and 5.
Functions (ANSI)	(F)-19-R	(F)-19-V
EO or N (01) Exit only, no trim.	 19-R-EO	 19-V-EO
DT (02) Entrance by trim when actuating bar is dogged down.*	 19-R-DT	 19-V-DT
NL (03) Entrance by trim when latchbolt is retracted by key. Key removable only when locked.	 19-R-NL	 19-V-NL
K or L or KIL(08) Entrance by knob or lever. Key locks or unlocks knob.	 19-R-K or L or KIK or KIL	 19-V-K or L or KIK or KIL
K(NL) or L(NL) (09) or KIL (NL) Entrance by knob or lever only when released by key. Key removable only when locked.	 19-R-K (NL) or L(NL) or KIK(NL) or KIL(NL)	 19-V-K (NL) or L(NL) or KIK(NL) or KIL(NL)



Fire exit hardware

Use "F" prefix for fire exit hardware.



Security monitor



Electric function

*Latch, device, and authorize degress monitors. (See electrified hardware catalog.)

*Fire exit devices cannot be dogged down. Some codes permit electric dogging with fail secure circuitry.

Type and functions

Double doors

Device & trim	Length	Top strike	Bottom strike	Min. stile	Door opening width
(F) 19-V	3'0"	3788	2130	3 1/2"	2' 5 1/4" to 3'0"
(F) 19-V	4'0"	3788	2130	3 1/2"	3'0" to 4'0"

Note: For (F-) 19-V-LBR use "V" information less bottom strike. F-19-V-LBR requires use of auxiliary fire latch.

Single doors with 5/8" stop

Device & trim	Length	Strike	Min. stile	Door opening width
19-R	3'0"	F570 565	3 1/2" 1 3/4"*	2'5 1/4" to 3'0" 2' 4 3/4" to 2' 9 1/4"
F-19-R	3'0"	F570	3 1/2"	2'5 1/4" to 3'0"
19-R	4'0"	F570 565	3 1/4" 1 3/4"*	3'0" to 4'0" 3'0" to 3'9 3/4"
F-19-R	4'0"	F570	3 1/4"	3'0" to 4'0"

*For EO and NL functions only. 2- 1/4" minimum stile required for control trim.

Dimensions:

- Recommended height from finished floor - 40 5/16" at CL.
- Touchbar projections: neutral - 2 1/2" depressed - 1 7/8"
- Extension rods or longer top rods available upon request.
- Specify door height.
- Dummy touchbar available. Specify 190 DT 3' or 4'.
- Overall length: 3' 30 1/2"- 4' 42 5/8"
- Changes for minimum door size for charts on left:
- For cylinder dogging, add 2 1/4" to minimum door size.
- For exit alarm, add 4 1/2" to minimum door size.
- To fit on smaller door consult factory

Double doors with Mullion

Device & trim	Length	Strike	Min. stile	Door opening width	Fire	Panic
19-R	3'0"	F570	3 1/2" 3 3/4"	2'5 1/4" to 3'0"	-	29231 4023/ KR4-23
		565	3 1/8" 3 3/8"	2'4 3/4" to 2'9 1/4"	-	29231 4023/KR4023
F-19-R	3'0"	F-570	3 3/4"	2'5 1/4" to 3'0"	(F)4023 KR(F)4023	-
19-R	4'0"	F570	3 1/2" 3 3/4"	3'0" to 4'0"	-	29231 4023/ KR4-23
		565	3 1/8" 3 3/8"	3'0" to 3'9 3/4"	-	29231 4023/KR4023
F-19-R	4'0"	F-570	3 3/4"	3'0" to 4'0"	(F)4023 KR(F)4023	-

¹ To cover 161 cutout on double door installation, specify 2923 mullion with 565 strike.

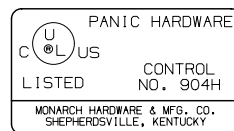

Door applications

Door thickness

All devices and components supplied for 1 3/4" doors standard. Specify door thickness if other than 1 3/4".

Number	BHMA/ANSI function
01	Exit only, no trim.
02	Entrance by trim when actuating bar is locked down.
03	Entrance by trim when latchbolt is retracted by key; key removable only when locked.
04	Entrance by trim when latchbolt is retracted by key or set in a retracted position by key.
08	Entrance by knob or lever; key locks or unlocks knob or lever.
09	Entrance by knob or lever only when released by keys; key removable only when locked.

U.S. standard	BHMA	Description
US28	628	Anodized aluminum – clear
DC13	710	Anodized aluminium – dark bronze
DC35	711	Anodized aluminum – black
P28	689	Painted aluminum – silver
P13	695	Painted aluminum – dark bronze
P35	622	Painted aluminum – black
US3	666	Bright brass
US4	667	Satin brass
US9	705	Bright bronze
US10	668	Satin bronze
US10B	703	Oxidized satin bronze
US14	669	Bright nickel
US15	670	Satin nickel
US26	672	Bright chrome
US26D	702	Satin chrome

Door application chart

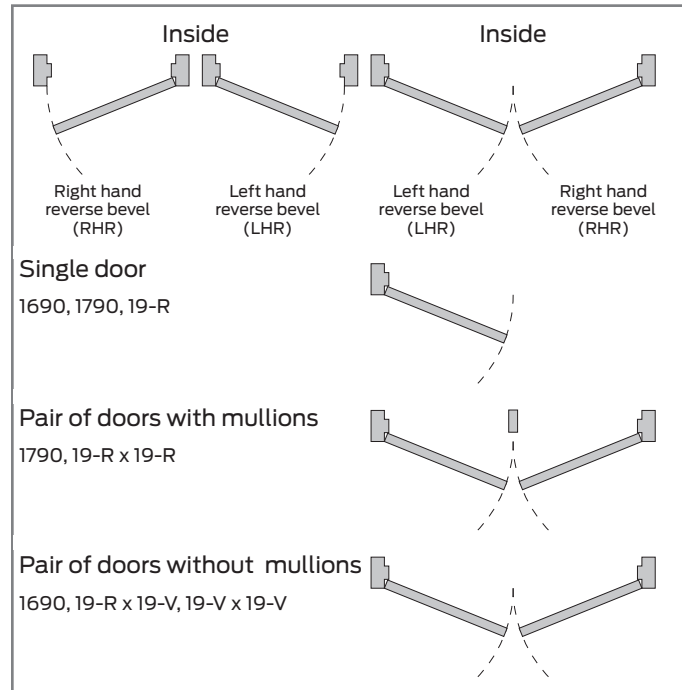

Device	Label	Door opening	Application
Hollow metal door			
F-19-R	1 1/2 hr. "B"	4' x 7'2" 8' x 7'2"	Single, pair, same egress w/ F-4023 mullion and KR-F-4023
F-19-V	1 1/2 hr. "B"	8' x 10'	Pair, double egress, same egress
F-19-V-LBR	1 1/2 hr. "B"	8' x 8'	Pair, double egress, same egress
Wood door			
F-19-V-LBR	20 min.	8' x 8'	Wood or comp., pair, double egress, same egress
F-19-R	1 1/2 hr. "B"	4' x 7'2" 8' x 7'2"	Single, pair, same egress w/ F-4023 mullion and KR-F-4023

19 Device dimensions:

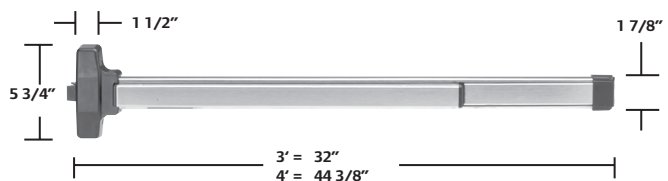

Strikes

1690 Concealed vertical rod device



PB48
Top strike for 1690 device. Packed with three 0.050" thick shims. 1 1/16" x 1 1/16" x 7/16" (H x W x D)

1790 Rim device



STK45
Strike for inactive leaf, pair of doors with 1790 device. 3 1/4" x 1 5/16" x 1/4" (H x W x D)



TD35
Strike for single doors, 1790 device. Includes 1/8" shim. 3" x 2" x 1/2" (H x W x D)

(F) 19-R Rim devices



F570
Standard strike. 2 5/8" x 1 1/4" x 13/16" (H x W x D)



F490
Optional strike. 2 5/8" x 1 1/4" x 7/8" (H x W x D)



565
Adjustable surface mounted for use with blade or applied stops. Mounts flush for 1/2" stop height.



571/571A
Used on inactive leaf for device on active leaf of pair of doors without removable mullion. 571 keeps 2 5/16" backset. 571A is trimmer and projects less into opening.

(F) 19-V Surface vertical rod devices



3788
Top strike for 19-V.



2130
19-V bottom strike for grouting into concrete or masonry floors.



4155
19-V optional bottom strike.



2126A
19-V optional bottom strike.

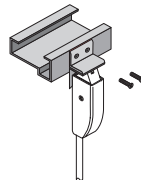

4215
Angle bracket for 19-V devices flush transom applications. Does not require elimination of latch retention feature.



Extension rods
Extension rods are available in 12", 24" and 36" lengths in all finishes. Both ends tapped and all-thread included as connector.

Power supply



The PS900 series is a consolidated line of power supplies and accessories that offer enhanced flexibility and functionality specific to the changing needs of the access control market. The PS900 series can be used in a variety of applications to convert high voltage AC power into the low voltage DC outputs required by most access control devices. The PS900 series protects devices downstream by providing Class 2*, filtered and regulated power. The full line is UL294 certified.

Note: PS906 can provide Class 2 rated outputs when used with 900-8P distribution board.

Features:

- Constant output rating at both 12 VDC and 24 VDC provides superior performance ; includes field selectable jumper
- Polarized connectors for option boards eliminate need for racks and side connectors
- Flat mounting of option boards provides easier access to terminal blocks for connection of electrified devices
- High voltage protective cover
- Battery back-up board auto-selects voltage
- Fire alarm relay can be configured to provide either switched or un-switched outputs from a power supply
- PS914 designed with high in rush current for powering electrified panic devices
- Universal 120-240 VAC input
- Low voltage DC, regulated and filtered
- Electronic power limiting foldback circuit for AC current overload protection
- Fused primary input
- AC status monitor- isolated SPDT contacts
- AC input and DC output LED status indicators
- Cover mounted AC input indication
- Hinged cover with lock down screws

Certifications:

- UL 294 certified—the standard for access control
- Class 2 rated*

* Except PS906, output rating exceeds Class 2 power limits

Once power is converted to low voltage DC, the PS900 Series offers a variety of distribution options, including basic fuse

protection, simple relay, and advanced logic providing complex sequencing and timing functions.

* PS906 can provide Class 2 rated outputs when used with 900-8P distribution board.

	PS902	PS904	PS906	PS914
Number of connectors on power supply for the following:				
2 amps				
4 amps				
6 amps				
4 amps				
Distribution boards	1	2	3	2
Battery back-up board	1	1	1	1

Note: One fire alarm board can be connected directly to the PS902. If a fire alarm board is desired for the PS904, PS906 or PS914 it can be connected to a distribution board.

Applications:

The PS900 series of power supplies works with many electrified devices including Falcon exit devices, electromagnetic locks, hardwired locks, electrified mechanical locks, electrified strikes and many other products.

Accessories:

The PS900 series features seven option boards for use in a variety of applications. All PS900 series power supplies option boards are UL 294 certified.

Option boards:

900-4R: 4 relay controlled output board to power multiple devices

900-4RL: 4 relay distribution board with logic is field configurable for time delay function, auto operator, security interlock

900-8F: Provides 8 individually fuse-protected outputs, giving the flexibility to power multiple devices and provide another layer of protection

900-FA: Emergency interface relay integrates with fire alarm and is used to cut power in case of emergency

900-BB: Battery backup

900-2RS: 2 relay EL panic device control board (PS914 only)

900-BBK: Battery backup kit includes two 7A/hr batteries and provides up to four hours of backup power when cycled every 5 minutes at full load.

Wire selection size / type

Run length	EL device w/ EPT or door loop
0-100 ft	14 gauge standard wire
101-200 ft	12 gauge standard wire
Run length	EL device w/ electric hinge / pivot
0-75 ft	14 gauge standard wire
76-150 ft	12 gauge standard wire
Wire selection	Switch wire size
1200 ft max.	16 gauge

Accessories

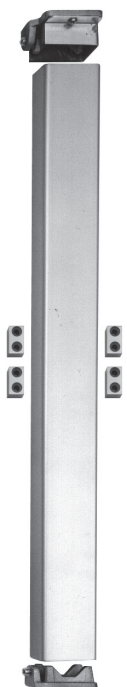

F-4023 Shown

Removable mullion

- Removable mullions are easily removed and reinstalled for full width access
- Increased security and tighter closure
- Minimizes door warp age and sag
- Regulates the traffic flow in-and-out
- Rim devices are used on both leaves, attaining a perfect symmetrical opening
- Mullion assembly consists of a mullion, top and bottom fittings and mounting package
- Mullion can be cut on the job for doors under stock lengths

2923, (F)4023, (F)KR4023 Mullion

These steel mullions can be used with the 19-R and F-19-R devices. Soffit adapters are available for the 2923 and 4023 mullions. The F4023 and F-KR4023 fire-rated mullions also include four stabilizer blocks as required for labeled installations. Strikes are not included with mullion and should be specified with the 19-R or F-19-R device, see page 11 for strike information. KR mullions require 1 1/4" mortise cylinder with standard "A" cam. The mullion fittings are made from ductile iron. The (F)4023 and (F)KR4023 are 2" wide and 3" deep. The 2923 is 1 1/2" wide and 2 1/2" deep. Furnished in prime coat.

Mullions



RM 170

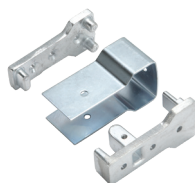

Mullion brackets



525 Mullion stabilizer for RM170

RM 170 Removable mullion

RM 170 for use with 1790 series. Comes complete with adjustable mortised strikes and security clips. Compatible with doors 7' to 10' and for use with stiles as narrow as 1 3/4". Made of aluminum, available in anodized aluminum or bronze finishes. Mullion is 3 1/2" deep, 1" wide on door side, and 1 5/8" at the widest point.

Mullion strikes



STK170

Adjustable mortise strikes (pair).

2 7/8" tall
1 3/4" wide
1" thick

Sex bolts

Sex bolts are available for 1 3/4" door thickness. Screws to fit are available in 3/4" and 2" lengths to cover a wide range of door thicknesses.

2729 (#10-24 thread)

4122 (1/4"-20 thread)

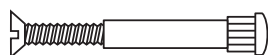

Filler plates

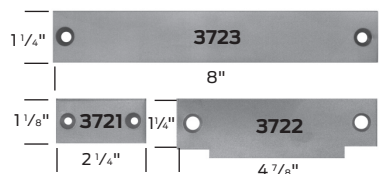

3721/3722/3723

Steel filler plates

3721 Cylindrical lock frontfiller

3722 ASA strike filler - set no. SC for 161 cutout

3723 Mortise lock front filler

3722 ASA strike filler - set no. SM for 86 cutout

Accessories

Popular EL application

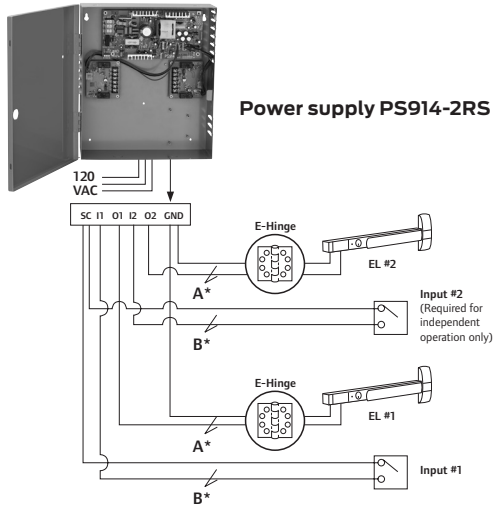

EL Device wire selection size

A*	Run length	EL device w/EPT or door loop
	0-100 ft.	14 gauge
	100-200 ft.	12 gauge

A*	Run length	EL device w/electric hinge/pivot
	0-75 ft.	14 gauge
	76-150 ft.	12 gauge

B*	Wire selection	Switch wire size
	1200 ft. max.	18 gauge

How to order

1490/1590

		EL	1490	EO	36"	US28	CYL	RL*	RHR*
HH	Hurricane device *								
EL	Electric latch retraction								
S	Signal switch - monitors latch bolt								
1490	See model numbers on page 4								
1590	See model numbers on page 5								
EO	Exit only								
DT	Dummy trim								
NLOP	Night latch cylinder assembly - optional pull								
HBOP	Hold back cylinder assembly - optional pull								
NLP	Night latch cylinder assembly with 9970 pull								
HBP	Hold back cylinder assembly with 9970 pull								
36"	36" (standard)								
42"	42" (optional)								
48"	48" (optional)								
US28	DC35 US9 US4 US14								
DC13	US3 US10 US10B US15								
RISER	Riser (1/2")								
CYL	Rim cylinder								
7 PIN CYL	Cylinder assembly for 7-pin cylinder. Cylinder not included.								
RL	Standard bottom latch								
HEX	Standard EL bottom latch								
PL	Pullman bottomlatch								
LBR	Less bottom rod								
RHR	RHR								
LHR	LHR								

*Applies to 1490 only

1690/1790

		EL	1690	EO	36"	US28	RL*
HH	Hurricane device*						
RX	Request to exit switch						
EL	Electric latch retraction						
ED	Electric dogging						
1690	See model numbes on page 6						
1790	See model numbers on page 7						
EO	Exit only						
DT	Dummy trim						
NL-HBOP	Cylinder assembly - optional pull						
NL-HBP	Cylinder assembly with 9970						
30"	30" (optional)						
36"	36" (standard)						
42"	42" (optional)						
48"	48" (optional)						
US28	DC35 US10 US26D						
DC13	US3 US26						
1690 Only							
HEX	Standard bottom latch						
RL	Rod bottom latch						
PL	Pullman lottomlatch						
ES	Top latch for use with electric strike						
LESS RODS	Less rods (retrofit of 1990 device)						
LBR	Less bottom rods						

*Applies to 1690 Only

19 Series

	F	19	V	L-DANE	US32D	3'	L	HR	LBR	SNB	WD
Prefixes											
CD											
KOR											
Rating F Fire exit hardware Blank Panic exit hardware											
Device Series 19 Touch bar device, narrow stile											
Device Type R Rim V Surface vertical rod											
Trim Function (see Trim pages for all functions) EO Exit only DT Dummy trim NL Night latch C Cylinder trim less pull K Knob L Lever (dane standard) TL Thumb lever KIL Key in lever											
Finish US32D SP28 SP313											
Door Width 3' Standard default 4' - Specify exact door width											
Handing RHR Right hand reverse LHR Left hand reverse											
Less bottom rod LBR Less bottom rod LBR-AFL LBR w/auxiliary fire latch											
Other device options RBB Round bottom bolt SSTB Stainless steel touch bar VRP Black pad on touch bar TAC Tactile warning											
Accessories CYL Cylinder SNB Sex bolts SK Shim kit AMS All machine screws											
Other miscellaneous door information HMD Hollow metal door HMF Hollow metal frame WD Wood door WDF Wood frame ALD Aluminum door ALF Aluminum frame SCDC Steel channel door construction - Specify other door or frame - Material information - Door height - Door thickness - Door undercut - Door label (20 min, 45 min, 90 min 1-1/2 hr) - Stile width - Frame stop height SGL Single door PR Pair of doors swinging same direction											

About Allegion

Allegion (NYSE: ALLE) creates peace of mind by pioneering safety and security. As a \$2 billion provider of security solutions for homes and businesses, Allegion employs more than 8,000 people and sells products in more than 120 countries across the world. Allegion comprises 27 global brands, including strategic brands CISA®, Interflex®, LCN®, Schlage® and Von Duprin®.

For more, visit www.allegion.com

KRYPTONITE ■ LCN ■  ■ STEELCRAFT ■ VON DUPRIN