



CL3800 Series

Standard-Duty Key-in-Lever Locksets

Product Catalog

Experience a safer
and more open world

Features

Handing

Non-handed.

Door Thickness Adjustment

Standard 1-3/8" to 1-7/8" (35 to 48mm); factory set for 1-3/4" doors. For 2" (51mm) and 2-1/4" (57mm) doors, specify door thickness. See Quick Codes, page 9-10.

Lock Chassis

Steel, zinc dichromated for corrosion resistance.

Backset

2-3/4" (70mm) standard. Optional: 2-3/8" (60mm), 3-3/4" (95mm) and 5" (127). See Quick Codes, page 9-10.

Latchbolt

1/2" (13mm) throw latch with universal "floating" front to fit both flat and beveled doors. 2-1/4" x 1-1/8" (57 x 29mm) square corner front for 2-3/4" (70mm) backset standard. For other latch options, See Quick Codes, page 9-10.

Auxiliary Latchbolt

Deadlocking latchbolt prevents manipulation when door is closed.

Strike

ANSI curved lip strike standard, 4-7/8" x 1-1/4" x 1-1/4" (124 x 32 x 32mm) lip to center. Optional strikes, lip lengths and ANSI wrought strike box available; See Quick Codes, page 9-10.

Cylinder

Brass, 6-pin, L4 keyway, "0" bitted standard.

Keying Features Available

Conventional 6-pin
Conventional 7-pin
Master keying
Construction master keying
Visual key control
Concealed key control
Pyramid® Security
Pyramid High Security
Interchangeable core (IC)
Security
Security IC
Pyramid Security IC
Pyramid High Security IC
Access 3®

Keys

Two nickel silver standard.

Warranty

Five-year limited.

Vandal Resistance

All functions feature the Lever Release™ design for vandal resistance, allowing the outside lever to rotate when in the locked position.

Certification/Compliance

ANSI/BHMA BHMA CERTIFIED

Certified A156.2 Series 4000, Grade 2. Meets A117.1 Accessibility Code.

Federal

Meets FF-H-106C.

California State Reference Code

(Formerly Title 19, California State Fire Marshal Standard)

All levers with returns comply; levers return to within 1/2" of door face.

UL-cUL

All locks listed for "A" label single doors.

Letter "F" and UL symbol on latch front indicate listing.

Any retrofit or other field modification to a fire rated opening can potentially impact the fire rating of the opening, and Corbin Russwin, Inc. makes no representations or warranties concerning what such impact may be in any specific situation. When retrofitting any portion of an existing fire-rated opening, or specifying and installing a new fire-rated opening, please consult with a code specialist or local code official (Authority Having Jurisdiction) to ensure compliance with all applicable codes and ratings.

Windstorm/Hurricane Hurricane

Certified (refer to local codes).

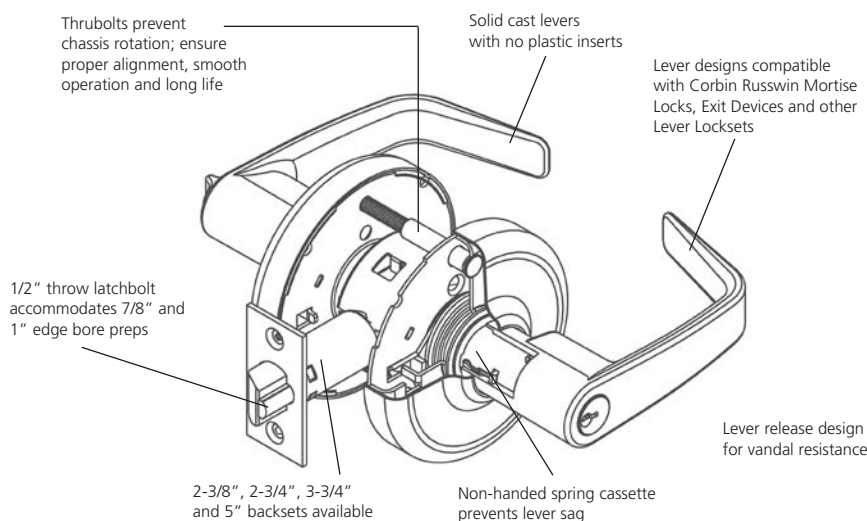

Functions

CL3800 Series

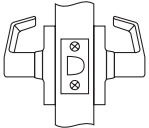
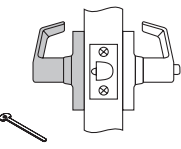
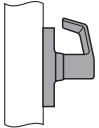
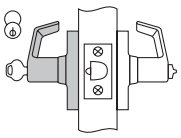
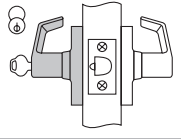
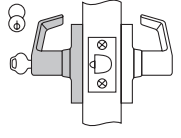
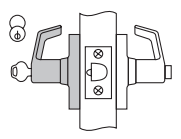
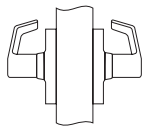
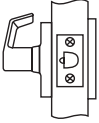
Outside	Inside	Series/Function	Type	ANSI No.	Function Description
		CL3810	Passage or Closet	F75	<ul style="list-style-type: none"> Latchbolt by lever either side Both levers always free.
		CL3820	Privacy Bedroom or Bathroom	F76A	<ul style="list-style-type: none"> Throw-off latchbolt by lever either side, except when push button locks outside lever. (Lever handle is free-wheeling in locked position.) Outside lever locked by push button. (Lever handle is free-wheeling in locked position.) Outside lever unlocked by emergency release tool, by rotating inside lever or by closing door. Inside lever always free.
		CL3850	Half Dummy Trim	—	<ul style="list-style-type: none"> Lever acts as pull only; no operation. Lever is rigid.
		CL3851	Entrance or Office	F109	<ul style="list-style-type: none"> Deadlocking latchbolt by lever either side except when turn button locks outside lever. (Lever handle is free-wheeling in locked position). Pushing turn button locks outside lever, requiring use of key outside to unlock. Turning inside lever unlocks outside lever. Pushing in and turning button locks outside lever, requiring key at all times. Turning inside lever does not unlock outside lever until button is manually turned to unlocked position. Inside lever always free.
		CL3855	Classroom	F84	<ul style="list-style-type: none"> Deadlocking latchbolt by lever either side except when key outside locks outside lever. (Lever handle is free-wheeling in locked position.) Outside lever unlocked by key outside. Inside lever always free.
		CL3857	Storeroom or Closet	F86	<ul style="list-style-type: none"> Deadlocking latchbolt by key in outside lever or by rotating inside lever. Outside lever always locked (lever handle is free-wheeling in locked position). Inside lever always free.
		CL3861	Entry or Office	F82A	<ul style="list-style-type: none"> Deadlocking latchbolt by lever either side, except when push button locks outside lever. Push button released by turning inside lever or by key in outside lever. (Lever handle is free-wheeling in locked position.) Closing door does not release push button. Inside lever always free.
		CL3870	Full Dummy Trim	—	<ul style="list-style-type: none"> Levers act as pulls only; no operation. Levers are rigid.
		CL3880	Passage Lever x Blank Plate	F111	<ul style="list-style-type: none"> Deadlocking latchbolt by lever. Lever on one side; blank plate on the other. Lever always free. For single or double communicating doors.

Trim Designs

CL3800 Series

Armstrong



AZD

Lever: Die-cast zinc
Rose: Wrought brass or bronze

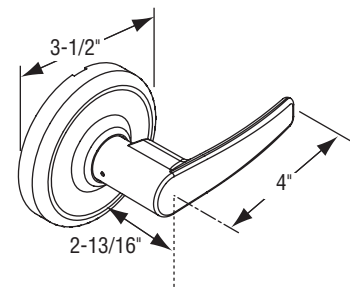

Newport

Complies with codes requiring lever to return to within 1/2" (13mm) of door face.



NZD

Lever: Die-cast zinc
Rose: Wrought brass or bronze

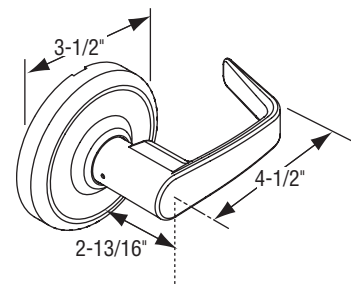

Princeton

Complies with codes requiring lever to return to within 1/2" (13mm) of door face.



PZD

Lever: Die-cast zinc
Rose: Wrought brass or bronze

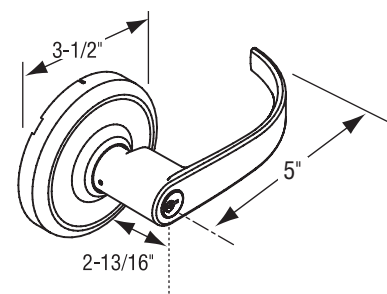

Options & Accessories

CL3800 Series

Latches

To order optional latchbolt with lockset, see How to Order, page 8.
To order latchbolt separately, specify Part No. x Finish (e.g., 599F91 x 626).

Backset and Front Description		Plain	Deadlocking	Throw-Off
2-3/8" Backset	1" width, square corner	599F91	599F92	599F93
	1" width, rounded corner	599F94	599F95	599F96
	1-1/8" width, square corner	599F97	599F98	599F99
	1-1/8" width, rounded corner	600F00	600F01	600F02
2-3/4" Backset	1" width, square corner	600F03	600F04	600F05
	1" width, rounded corner	600F06	600F07	600F08
	1-1/8" width, square corner	600F09	600F10	600F11
3-3/4" Backset	1-1/8" width, rounded corner	600F12	600F13	600F14
	1-1/8" width, square corner	600F62	600F63	600F64
5" Backset	1-1/8" width, rounded corner	600F65	600F66	600F67
	1-1/8" width, square corner	600F68	600F69	600F70
	1-1/8" width, rounded corner	600F71	600F72	600F73

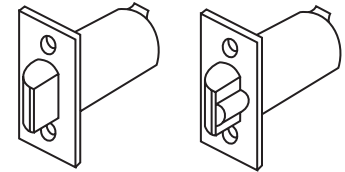

Plain (CL3810) Deadlocking (All other functions)

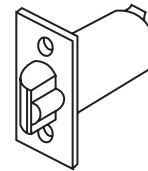

Throw-Off (CL3820, CL3893 & CL3840)

Housing diameter 7/8" for all models. 1" diameter latch sleeve furnished with each latchbolt.

Cylinders

		Standard Cylinder	Interchangeable Core
		.509" plug diameter conventional .510" plug diameter Access 3® .552" plug diameter security .496" plug diameter Pyramid Brass, 6-pin 2 nickel silver keys Finishes: 606, 626	.509" plug diameter conventional .510" plug diameter Access 3® .552" plug diameter security .496" plug diameter Pyramid Brass, 6-pin 2 nickel silver keys Finishes: 605, 606, 611, 612, 613, 613E, 625, 626, 722, BSP, WSP
Conventional	6-pin	2000-033 (standard)	8000
	7-pin	2000-033-7	8000-7
Security	6-pin	2010-033	8010
Pyramid High Security	7-pin	2020-033	8020
Pyramid Security	7-pin	2027-033	8027
Access 3® AP	6-pin	2500-033	8500
Access 3® AS	6-pin	2600-033	8600
Access 3® AHS	6-pin	2700-033	8700
Schlage® C Keyway	6-pin	2400-033-C	—
Sargent® LA Keyway	6-pin	2400-033-LA	—

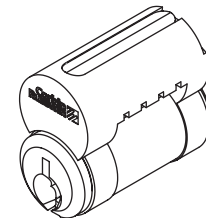
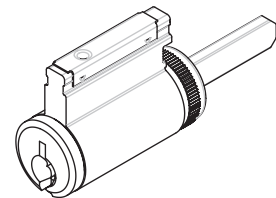

To order optional cylinder with lockset, see How to Order, page 8.
To order cylinder separately, specify Part No. x Keyway x Finish (e.g., 8000 x L4 x 626).

Compatibility with Competitive Cylinders

Competitive Cylinder	Parts Required for Installation
Schlage conventional 21-002, 23-001 or 23-013	682F398 tailpiece included with M06 option.
Schlage Primus 20-548, 20-550, 20-748 or 20-750	682F398 tailpiece included with M06 option.
Schlage 6-pin Interchangeable Core	Specify M69 - 697F942 Tailpiece included with M69 option.
SFIC style core, 6 or 7-pin	682F95-8 tailpiece kit and special lever (NZD and PZD designs only) included with M08 option. Accommodates 6 and 7-pin cores.
Sargent fixed core C10-1	599F38-9 Tailpiece kit and special lever. Included with M09 options. See How to Order, page 8.

For Assa® and Medeco® retrofit cylinders, consult those manufacturers' catalogs.

Quick Codes

CL3800 Series

Cylinder and Keying

Description	Specify
Conventional 6-pin	(standard)
Conventional 7-pin	7P
Less cylinder(s)	LC
IC 6-pin	C6
IC 6-pin with Temporary Construction Core (Red)	CT6R
IC 6-pin with Temporary Construction Core (Blue)	CT6B
IC 6-pin with Temporary Construction Core (Green)	CT6G
IC 6-pin less core	CL6
SFIC 6- or 7-pin Small Format Disposable Core	CTSD
IC 7-pin	C7
IC 7-pin less core	CL7
IC 7-pin with Temporary Construction Core (Red)	CT7R
IC 7-pin with Temporary Construction Core (Blue)	CT7B
IC 7-pin with Temporary Construction Core (Green)	CT7G
Security	HS
Security IC	CHS
Access 3 [®] AP Fixed Core	AP
Access 3 [®] AS Fixed Core	AS
Access 3 [®] AHS Fixed Core	AHS
Access 3 [®] AP IC	ACP
Access 3 [®] AS IC	ACS
Access 3 [®] AHS IC	ACHS
Pyramid High Security Fixed Core	PHS
Pyramid High Security IC	PCHS
Pyramid IC Less Core	CLP
Pyramid with temporary construction core	CTP
Pyramid Security Fixed Core	PS
Pyramid Security IC	PCS
Pyramid Disposable Core	CTPD
6-Pin Disposable Core	CT6D
7-Pin Disposable Core	CT7D
0-bitted with 2 blank keys	(standard)
Keyed random	KR
Construction master keyed	CMK
Visual key control (VKC)	
No bitting or keyset stamping on keys	VKC0
Keys only	VKC1
Cylinders and keys (not for HS, CHS, PHS, PCHS or Access 3 [®])	VKC2
Cylinders only (not for HS, CHS, PHS, PCHS or Access 3 [®])	VKC3
Concealed key control (CKC)	
CKC cylinders with VKC keys	CKC2
CKC cylinders only (not for PHS, PCHS, Access 3 [®])	CKC3
2 keys per lock	(standard)
More than 2 keys	KY# (e.g., KY6)
Schlage [®] C keyway cylinder	C
Sargent [®] LA keyway cylinder	LA

Finishes

Description	Specify
ANSI/BHMA 605 (US3)	Bright Brass, Clear Coated 605
ANSI/BHMA 606 (US4)	Satin Brass, Clear Coated 606
ANSI/BHMA 611 (US9)	Bright Bronze, Clear Coated 611
ANSI/BHMA 612 (US10)	Satin Bronze, Clear Coated 612
ANSI/BHMA 613 (US10B)	Dark Oxidized Satin Bronze, Oil Rubbed 613
613E	Dark Oxidized Satin Bronze, Equivalent 613E
613L	Dark Oxidized Satin Bronze, Clear Coated 613L
ANSI/BHMA 618 (US14)	Bright Nickel Plated, Clear Coated 618
ANSI/BHMA 619 (US15)	Satin Nickel Plated, Clear Coated 619
619C	Satin Nickel Plated with Microshield [®] 619C
ANSI/BHMA 625 (US26)	Bright Chrome Plated 625
ANSI/BHMA 626 (US26D)	Satin Chrome Plated 626
626C	Satin Chrome Plated with MicroShield [®] 626C
ANSI/BHMA 722	Black Oxidized Bronze, oil rubbed 722
BSP	Black Suede Powder Coat BSP
WSP	White Suede Powder Coat WSP

Strikes

ANSI Lip to Center	ANSI Curved Lip Specify	Curved Lip Box Specify	Full Lip Specify	Full Lip Radius Corner Specify
1" (25mm)	SA100	SC100	N/A	N/A
1-1/8" (29mm)	SA118	SC118	N/A	N/A
1-1/4" (32mm)	SA114 (standard)	SC114	SF114	SFR114
1-3/8" (35mm)	SA138	SC138	N/A	N/A
1-1/2" (38mm)	SA112	SC112	N/A	N/A
1-3/4" (44mm)	SA134	SC134	N/A	N/A
2" (51mm)	SA200	SC200	N/A	N/A
2-1/4" (57mm)	SA214	SC214	N/A	N/A
2-1/2" (64mm)	SA212	SC212	N/A	N/A
2-3/4" (70mm)	SA234	SC234	N/A	N/A
3" (76mm)	SA300	SC300	N/A	N/A

Door Thickness

Door Thickness	Specify
1-3/8" (35mm) - 1-7/8" (48mm)	(standard)
2" (51mm) - 2-1/4" (57mm)	D214

Backset

Description	Specify
2-3/8" (60mm)	B238
2-3/4" (70mm)	(standard)
3-3/4" (95mm)	B334
5" (127mm)	B500

Quick Codes

CL3800 Series

Miscellaneous Options

Description	Specify
Spanner head screws	M02
Torx® head screws	M04
Less cylinder, with tailpiece for Schlage® cylinder	M06
Lever to accept SFIC 6 or 7-pin interchangeable core (NZD & PZD design only)	M08
Lever to accept Sargent® cylinder (NZD & PZD designs only)	M09
Lever to accept Schlage® Interchangeable core (NZD & PZD design only)	M69
Rounded corners on latch front	M13
1" latch front, square corners (standard for 2-3/8" backset)	M14
1" latch front, rounded corners	M15
ANSI wrought strike box	M17
Knurling outside and inside	M20
Knurling outside only	M21
Knurling inside only	M22
Abrasive coat outside and inside	M23
Abrasive coat inside only	M24
Abrasive coat outside only	M25
1-1/8" front, square corners (standard for 2-3/4", 3-3/4" and 5" backsets)	M32