



BEST 
dormakaba Group

8K Series

Heavy Duty Cylindrical Locks – Knobs
by BEST



BEST: Setting the Standard for Security

TABLE OF CONTENTS

Features.....	2	Special Features.....	5
Certification.....	2	Functions.....	6-9
Patents.....	2	CORMAX™ Patented Keying System.....	10
Specifications.....	3	Deadlocking Latches & Strikes.....	10
How To Order.....	3	Door Preparation.....	11
Shipping Weights.....	4	Sample Specifications.....	11
Knob Styles & Trim.....	4	Service Equipment.....	12

8K Series – Features

- Quick, economical rekeying with the BEST® interchangeable core.
- Knobs machined from brass or bronze bar stock.*
- Rotating knob face provides for easy hand of door change without removing the knob.
- No keeper hole on keyed knobs for added security.
- Keyed knob removable only after the core is removed.
- The tactile or knurled knob feature designed for blind, safety and accessibility applications.
- Friction insert inside rose resists loosening.
- The optional breakaway feature prevents the lockset from being overpowered by a wrench.
- 9/16" throw, deadlocking latch.
- Spin free knob feature permits the lock to be operated only by use of a key.
- Steel retractor with low friction bearings for smooth, wear resistant operation.
- Long bearing length in chassis for smooth, wear resistant operation.

* All knob styles feature solid extruded knob material.

Products covered by one or more of the following patents: 5,590,555 5,794,472

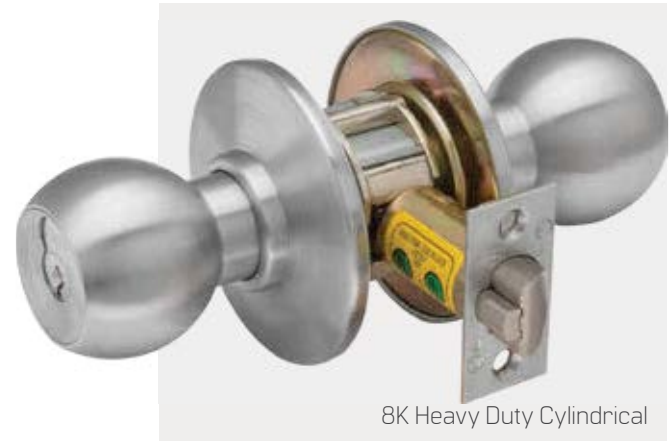

8K Heavy Duty Cylindrical

Certification

The 8K Cylindrical Lock meets or exceeds the following standards:

Builders Hardware Manufacturers Association: 8K series – Listed by BHMA for A156.2, Series 4000, Grade 1.

Underwriters Laboratories®: 8K series – Listed by Underwriters Laboratories for use on 3 Hr, A label for single or double swinging doors.

California State Fire Marshal: 8K series – Listed with California State Fire Marshal. Door thickness – Available for 1 3/4" to 2 1/4" doors only. Spacers available for 1 3/8" doors.



Specifications & How to Order

8K Specifications	
Materials	Internal parts are brass or corrosion-treated steel.
Chassis	2 1/16" diameter to fit 2 1/8" hole in door.
Backset	2 3/4" standard, 3 3/4" and 5" available.
Latch	9/16" throw. Front 2 1/4 x 1 1/8" beveled. Latch housing fits 1" hole in edge of door.
Knobs	Diameter – 2 1/8" Projection from door – 2 7/8" #4, #6 Knob Material – Machined from solid brass or bronze.
Roses	All roses are brass or bronze reinforced with steel liner. Roses are threaded to chassis. A – round, 3 3/4" diameter; C – round, 2 9/16" diameter; D – convex round, 3 3/8" diameter E – special trim for 2 1/8" to 3" thick doors
Door Thickness	Adjustable from 1 3/8" to 2" standard. Special "E" trim for 2 1/8" to 3" doors available. The "B" style square trim is for doors 1 3/4" to 2" only.
Strike	[STK] – 2 3/4" x 1 1/8" with curved lip and box standard (ANSI A115.3), [S3] – 4 7/8" x 1 1/4" with curved lip and box available [ANSI A115.2], [S3-7/8] – Conforms to ANSI A115.2 for 1 3/4" doors. [4 7/8" x 1 7/8" flat] STK [standard] – 2 3/4" x 1 1/8" with curved lip & box. [ANSI A115.2 for 1 3/8" doors]. S3 – 4 7/8" x 1 1/4" with curved lip & box. [ANSI A115.2 for 1 3/4" doors].
Latch & Strike Screws	[STK] Strike Package [1] 2 3/4" Strike plate, [4] #8-32 / #8-16 x 3/4" Phillips flat head screws. 8KS3 Strike [1] 4 7/8" Strike plate, [2] #8-32 / #8-16 x 3/4" Phillips flat head screws, [2] #12-24 / #12-12 x 3/4" Phillips flat head screws. Security head machine screws and driver can be ordered for added security.
Finishes	605 – bright brass, clear coated 606 – satin brass, clear coated 611 – bright bronze, clear coated 612 – satin bronze, clear coated 613 – oxidized satin bronze, oil rubbed 625 – bright chromium plated 626 – satin chromium plated; 690 – dark bronze coated

8K Series How To Order

8K	3	7	AB	4	A	STK	626		
Series	Backset	Core Housing	Function Code	Knob Style	Rose Style	Strike Package	Finishes	Options	
8K	3 – 2 3/4" 4 – 3 3/4" 5 – 5"	0 – keyless 7 – 7-pin housing accepts all Best cores	AB – entrance D – storeroom L – privacy N – passage R – classroom etc.	4 – round 6 – tulip	A – 3 3/8" C – 2 9/16" D – convex E – thick (not shown)	STK – standard S3 – ANSI S3 – 7/8" flat strike	605 606 611 612 613 625 626 690	BRK – breakaway (#4, #6) KNL – knurled (#6 knob) LL – lead lined SH – security head screws SPN – spin free (D&W function) (#4, #6 knobs) TAC – tactile knob (#4, #6) Note: specify inside (I), outside (O), or both (B) for KNL, TAC options 3/4 – 3/4" throw latch	
		pages 8–11	page 3	page 3	page 5			page 4	

** Must specify key mark and number of keys or designate L/C for less core.
8KS2 Strike (Standard)

Special Features



Breakaway Feature
When excessive force (approx. 300 inch lbs.) is applied to #4, #6 keyed knobs, they "breakaway" and spin freely, thus allowing entrance only by key. Simple part replacement returns lock to functional usage.

To order: Designate "BRK" on options of "How to Order" (page 5).

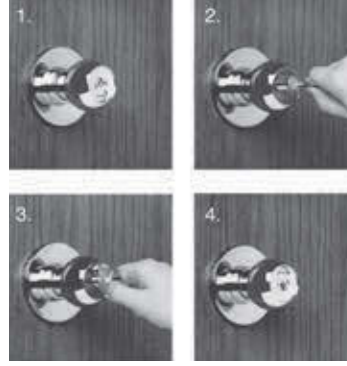

Reversible Knob Face

1. Core is upside down (wrong side)
2. Partially remove core with Control Key.
3. Rotate knob face 180 degrees.
4. Reinsert core with "BEST" in up position. The lockset is easily reversible for either hand of the door without removing the keyed knob.

Knurled Feature

This feature is available only on #6 knob only. The knurling is machined into the outer edge of the knob. The knurled feature can be used for blind, safety or accessibility applications.

To order: Designate "KNL" on options of "How to Order" (page 3).



Tactile Feature

Grooves are machined into the #4 and #6 solid brass or bronze knobs, to improve grip, or can be used as a warning in hazardous areas. This option can be used for blind, safety or accessibility applications.

To order: Designate "TAC" on options of "How to Order" (page 3).



Spin Free Feature

This unique feature is for #4, #6 knobs and is standard on H and HJ functions and optional on D and W. The spin free feature allows the outside knob to spin freely at all times while the core and knob face remain stationary, thus permitting the lock to be operated only by use of a key.

To order: Designate "SPN" on options of "How to Order" (page 3).



Lead Lined Feature

Lead lined can be used to protect against X-rays. Since the majority of lead lined doors contain the lead in the surface of the door, the 8K lockset provides lead lining for the holes cut in the door when preparing the door for the trim. A 3/16" lead slug is installed in the knob face.

To order: Designate "LL" on options of "How to Order" (page 3).

