



4700 Series Grade 1 Cylindrical Knob Lockset Installation Instructions

Tools Required For Replacement Installation

- (#2) phillips head screwdriver

Tools Required For New Installation

- (#2) phillips head screwdriver
- 2-1/8" (54) hole saw
- 1" (25) drill bit
- Chisel

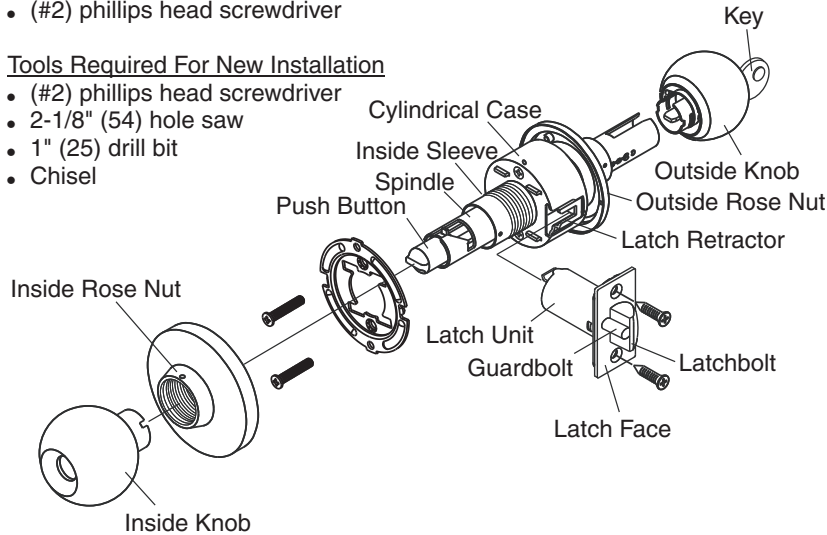

Attention Installer

Replacing Existing Entrance Locks:

Before beginning, measure from center of lock to door edge in order to check length of backset on existing lock. The backset length of the new lock is printed on the front of the package. If backset size is the same, continue; otherwise, you'll have to replace lock with proper size backset. Installation of cylindrical locks and latches must be through bolted in all doors. If installation instructions are not followed this may result in damage to the lock and void the factory warranty.

Any retrofit or other field modification to a fire rated opening can potentially impact the fire rating of the opening, and Yale Locks & Hardware makes no representations or warranties concerning what such impact may be in any specific situation. When retrofitting any portion of an existing fire rated opening, or specifying and installing a new fire-rated opening, please consult with a code specialist or local code official (Authority Having Jurisdiction) to ensure compliance with all applicable codes and ratings.

1. Mark Door

Mark one hole 2-1/8" (54mm) on door face.

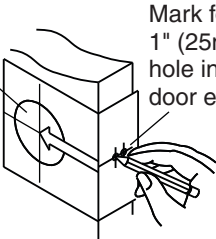

Mark for 1" (25mm) hole in door edge.

Fold and apply template to edge of door and mark center of door edge as indicated on template. Mark center hole on door face through guide on template.

(Note: Backset on door face must be same as backset of lock.)

2. Drill Holes

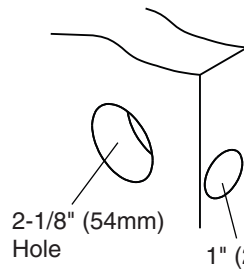

Drill 2-1/8" (54mm) hole through door face, drill 1" (25mm) hole in center of door edge for latch.

3. Install Latch

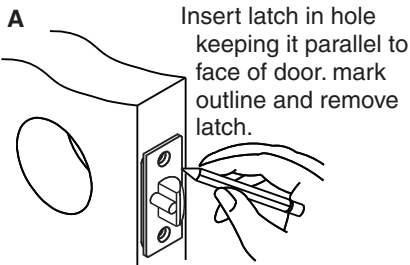

Insert latch in hole keeping it parallel to face of door. mark outline and remove latch.

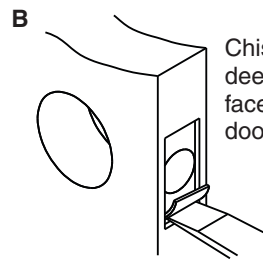

Chisel 5/32" (4mm) deep or until latch face is flush with door edge.

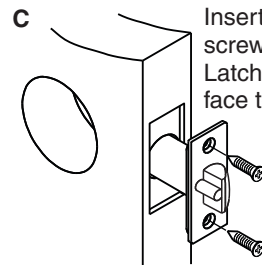

Insert latch and tighten screws. (NOTE: Latchbolt bevel must face to closing direction.)

4. Install Strike

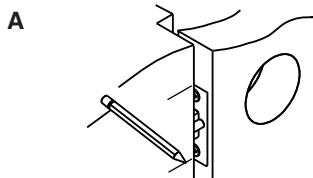

Close door until latchbolt touches jamb to locate strike in jamb and centerline of strike. Open door and extend line from mark to door stop. Measure one half of door thickness from door stop and vertically mark drill point center for strike.

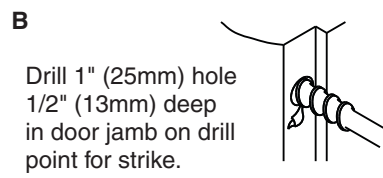

Drill 1" (25mm) hole 1/2" (13mm) deep in door jamb on drill point for strike.

CAUTION: To ensure proper lockset function, hole in jamb must be drilled a full 1/2" (12mm) deep.

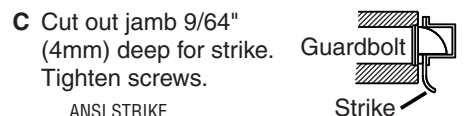

Cut out jamb 9/64" (4mm) deep for strike. Tighten screws.

ANSI STRIKE
Optional Strike Box
#202

Guardbolt stops against strike, as illustrated, preventing forcing when door is closed. Adjustable tab on strike permits bending in or out to eliminate too loose fit between door and door stop.



5. Remove Inside Knob

A Use nail end of wrench provided to depress inside knob catch in hole of inside sleeve collar and slide knob off spindle.

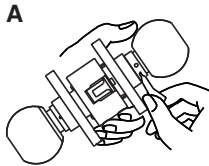

B Please use the wrench to loosen inside rose nut, then unscrew by hand.

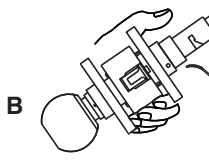

6. Adjust Outside Rose

Adjust lock to fit door thickness by rotating outside rose nut. Note: Lock must be centered on door to ensure latch bolt moves freely.

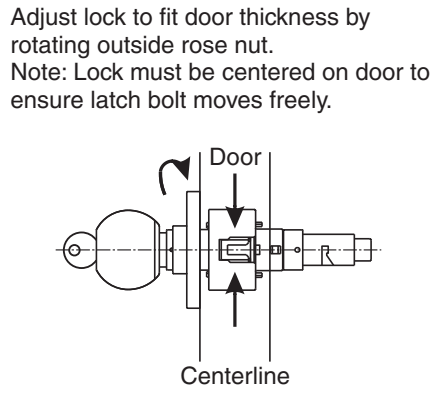

Centerline

7. Install Lock

Latch unit must be in place before installing lock. Be sure lock housing engages with latch prongs and retractor interlocks with latch tail.

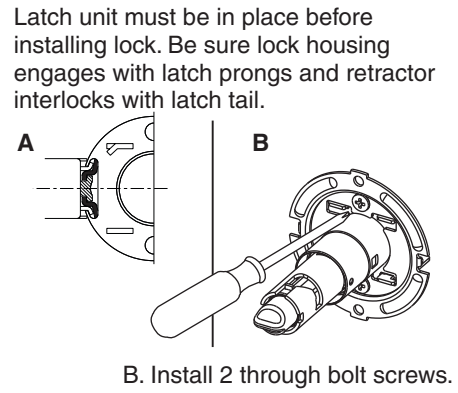

B. Install 2 through bolt screws.

8. Install Inside Rose

Insert inside rose and reinforcing plate into hole. Turn the reinforcing plate clockwise until the plate engaged with the hole, make sure the two rose grooves face to door hole, then use tool tighten inside rose securely.

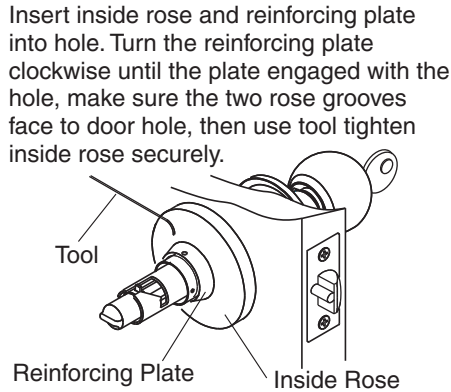

Tool
Reinforcing Plate
Inside Rose

9. Replace Knob

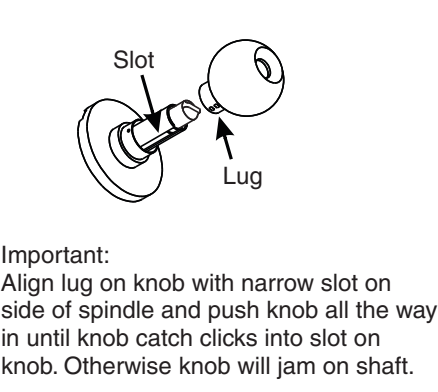

Slot
Lug

Important:
Align lug on knob with narrow slot on side of spindle and push knob all the way in until knob catch clicks into slot on knob. Otherwise knob will jam on shaft.

10. Correct Key Hole Position

Upon installation of the lock, it may happen that key hole faces upward or downward as shown in the following drawing. It is advisable to correct all key holes to be facing downward.

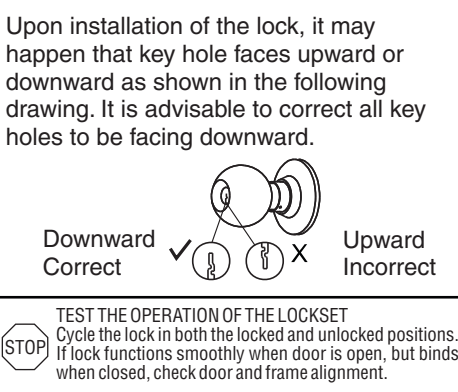

Downward Correct ✓ Upward Incorrect X

STOP TEST THE OPERATION OF THE LOCKSET
Cycle the lock in both the locked and unlocked positions. If lock functions smoothly when door is open, but binds when closed, check door and frame alignment.

11. IN ORDER TO ADJUST THE INCORRECT STATE OF THE KEY HOLE FACING UPWARD, THE KNOB MUST BE PULLED OUT AND INSTALLED AGAIN. THE METHOD OF INSTALLATION IS DESCRIBED AS BELOW.

A With the other hand, turn the key counter clockwise within the limit of 30° ~90°



B Using the nail end of the tool provided (or a small nail), press the knob catch and pull the knob off.

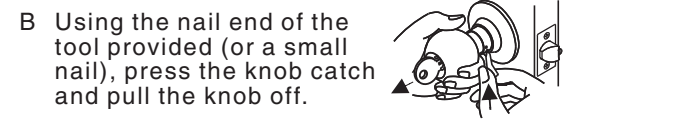

C Install again according to the correct direction. (See Step 10)

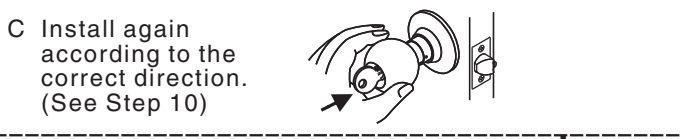
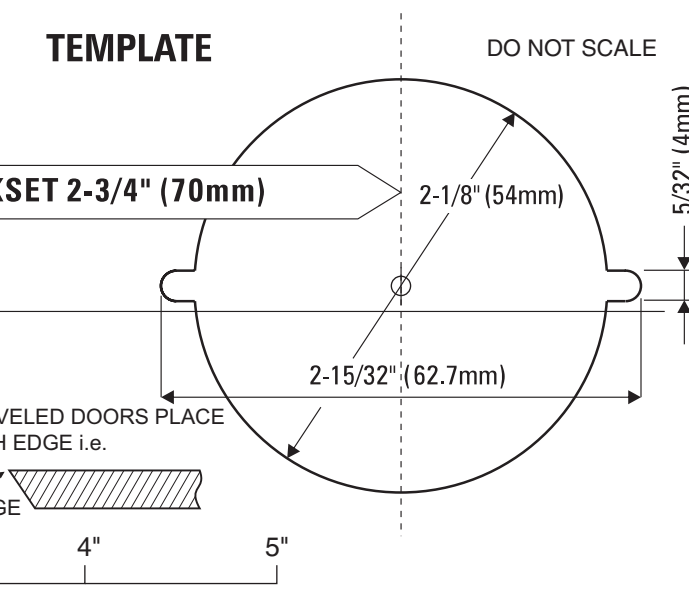
Yale Locks & Hardware

Product Support Tel 800.438.1951 • www.yalelocks.com

Yale Locks & Hardware is a division of Yale Security Inc., an ASSA ABLOY Group company.

Yale® is a registered trademark of Yale Security Inc., an ASSA ABLOY Group company. Other products' brand names may be trademarks or registered trademarks of their respective owners and are mentioned for reference purposes only. These materials are protected under U.S. copyright laws. All contents current at time of publication.

Yale Security Inc. reserves the right to change availability of any item in this catalog, its design, construction, and/or its materials.

Copyright © 2009, 2012, Yale Security Inc., an ASSA ABLOY Group company.

All rights reserved. Reproduction in whole or in part without the express written permission of Yale Security Inc. is prohibited.