



- Mechanical Pushbutton Lock
- Single Access Code
- Deadbolt/Spring Latch/Rim Deadlocking Latch
- Thumbturn

Features

Access Control:	Mechanical pushbutton lock eliminates problems and costs associated with issuing, controlling, and collecting keys and cards. Provides fully mechanical primary or auxiliary pushbutton access control by exterior combination, while allowing free egress at all times by interior thumbturn. Deadbolt models must be manually relocked. Deadlocking latch models automatically relock each time the door closes.
No Battery:	Fully mechanical lock eliminates the material and labor expense of battery replacements
Locking Device Options:	Deadbolt—must be manually relocked Deadlocking latch—relocks automatically when door closes Rim locking latch—relocks automatically when door closes; also has latch holdback
Number of Codes:	Single access code—one easy-to-manage code for all users
Programming:	Lock is easily programmed via keypad without removing lock from the door
Handing:	Field reversible
Operation Modes:	Single credential access Latch holdback (7106 only)
Economical:	A cost effective access control solution

Mechanical Features

Construction:	All metal cast front housing; force-resistant, clutch-protected exterior thumbturn
Numeric Keypad:	Vandal resistant, solid metal pushbuttons
Handing:	Field reversible
Finishes:	For all models except 7106: Bright Brass 03 (605), Satin Chrome 26D (626), Antique Copper (AC) (059), Gold Vein (GV) (060), Antique White (AW) (062), Silver Vein (SV) (061), Black 19 (676), and Antique Brass 05 (609) Model 7106: inside trim (Black only) All other Black models, inside trim (Satin Chrome)
Latch:	1" (25 mm) tubular deadbolt ½" (13 mm) deadlocking latch ⅝" (16 mm) rim deadlocking latch
Backset:	2¾" (70 mm) or 2⅝" (60 mm) backset
Strike:	Models 7102 and 7108: Flat deadbolt strike plate Model 7104: Curved lip strike plate Model 7106: Box strike for in-swing doors and flat strike for out-swing doors
Minimum Stile Required:	4" (102 mm)
Weight:	2.5 lbs. (1.1 kg)

Installation

Installation:	1 3/8" (35 mm) diameter through bore; 1" (25 mm) diameter cross bore; 3/4" (19 mm) through bore; 2 x 1/4" through bores
Door Thickness:	1 3/8" (35 mm) to 2 1/4" (57 mm), wood or metal
Items Supplied Include:	Installation manual, full-scale template and required installation hardware

Certification and Testing

Durability:	Weather resistant
--------------------	-------------------

Warranty

Warranty:	1-year warranty
------------------	-----------------

Auxiliary Lock

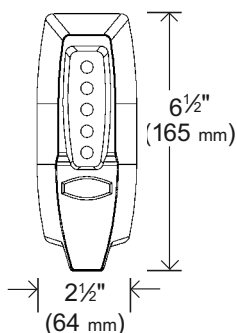

Exterior

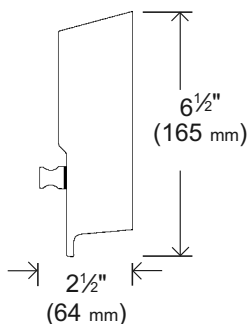

Exterior Side

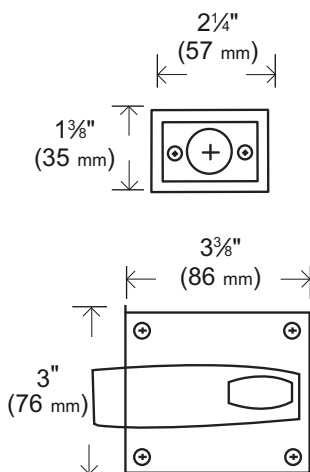
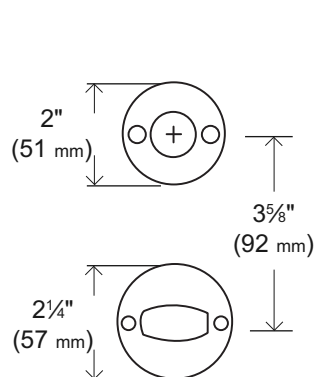

Models 7102, 7104, 7108

Models 7106

Interior

Model 7102

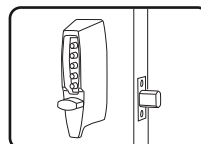

- 1" (25 mm) Tubular Deadbolt, Flat Face Plate
- Backset 2 3/4" (70 mm)
- Auxiliary Lock
- Manual Relock
- Numerous Finishes

Model 7104

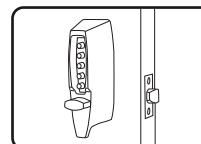

- 1/2" (13 mm) Deadlocking Latch, Flat Face Plate
- Backset 2 3/8"-2 3/4" (60-70 mm)—Adjustable
- Primary/Auxiliary Lock
- Automatic Relock
- Numerous Finishes

Model 7106

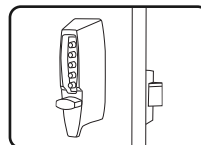

- 5/8" (16 mm) Rim Deadlocking Latch, Flat Face Plate
- Backset 2 3/8" (60 mm)
- For Wood Doors Only
- Auxiliary Lock
- Automatic Relock and Latch Holdback
- Select Finishes

Model 7108

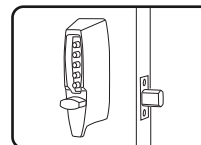

- 1" (25 mm) Tubular Deadbolt, Flat Face Plate
- Backset 2 3/8" (60 mm)
- Auxiliary Lock
- Manual Relock
- Numerous Finishes