

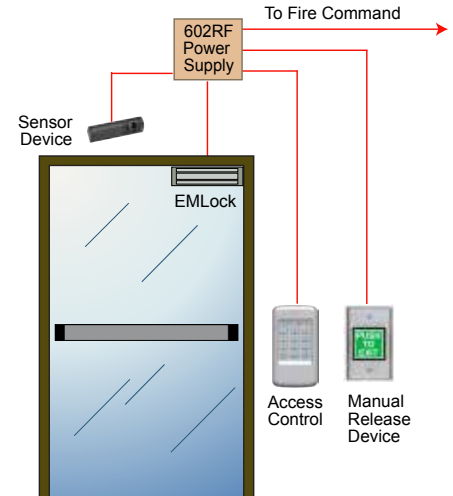

www.sdcsecurity.com service@sdsecurity.com
 [t] 800.413.8783 805.494.0622 [f] 805.494.8861
 801 Avenida Acaso, Camarillo CA 93012 • PO Box 3670, Camarillo CA 93011-3670

400M Series Exit Device / MD31D Sensor Device

Code Compliant Egress Devices Per Access-Controlled Egress Doors Criteria



Manual Release Device

The 400M series exit switch complies with national fire and building code requirements for manual releasing devices as specified for Access-Controlled Egress Doors.

413MNU

Narrow Request-To-Exit Switch
 1-3/4" x 1" Button, 1-3/4" Faceplate
 For narrow frame mount applications

423MU

Single Gang Request-To-Exit Switch
 2" square button, wall mount.

Features

- 30 second relock delay, fixed
- Retriggerable - pushing the switch at anytime restarts the timer cycle
- Failsafe mode releases lock when power to the switch is lost
- Sign: PUSH TO EXIT
- Illuminated push button

Specifications

Input: 35mA @ 12/24VDC
Output: SPST, Normally On,
 1 Amp @ 12/24VDC

Sensor Device

The MD31D series REX sensor complies with national fire and building code requirements for sensor device as specified for Access-Controlled Egress Doors.

MD-31D-W

PIR Request-to-Exit Sensor, White

MD-31D-B

PIR Request-to-Exit Sensor, Black

Features

- 1-60 second relock delay
- Frame, wall or ceiling mounted
- Pointable U shape coverage field from 5' x 6' to 10' x 12'

Specifications

Input: 12/24V AC/DC @ 26mA max
Output: 2 SPDT Dry, 1 Amp @ 30VDC
Operating temp: 32° F to 122° F
 (0° C to 50° C)
Dimensions: 2" H x 7" W x 2" D
 (5.1 H x 17.8 W x 5.1 D cm)



294 Access Control Systems Unit

Code Compliance

413MNU and 423MU exit switches and MD31D PIR sensor comply with the manual releasing device and sensor device requirements of national building and fire life safety codes.

- **ICC International Building Code**
1008.1.3.4
- **IFC International Fire Code**
1008.1.3.4
- **NFPA 101 Life Safety Code**
7.2.1.6.2
Access-Controlled Egress Doors
- **California Fire Code**
1008.1.3.4

SECURITY DOOR CONTROLS

sdsecurity.com
 service@sdsecurity.com

