

**PARTS LIST**  
**1331 SERIES DOOR CLOSER**  
**25-JO REGULAR ARM**

**PARTS LIST**

PAGE REV.  
 No. No.  
 2D B

3/2011

ITEM No.	PART No.	DESCRIPTION	QTY.
1	*61-2761	JO MAIN ARM ASSEMBLY	1
2	*63-2216	FOOT ASSEMBLY	1
3	*61-0308	SWIVEL ARM SCREW	1
4	*01-1140	#10-24 x 3/8" PHILLIPS PAN HEAD M.S.	1

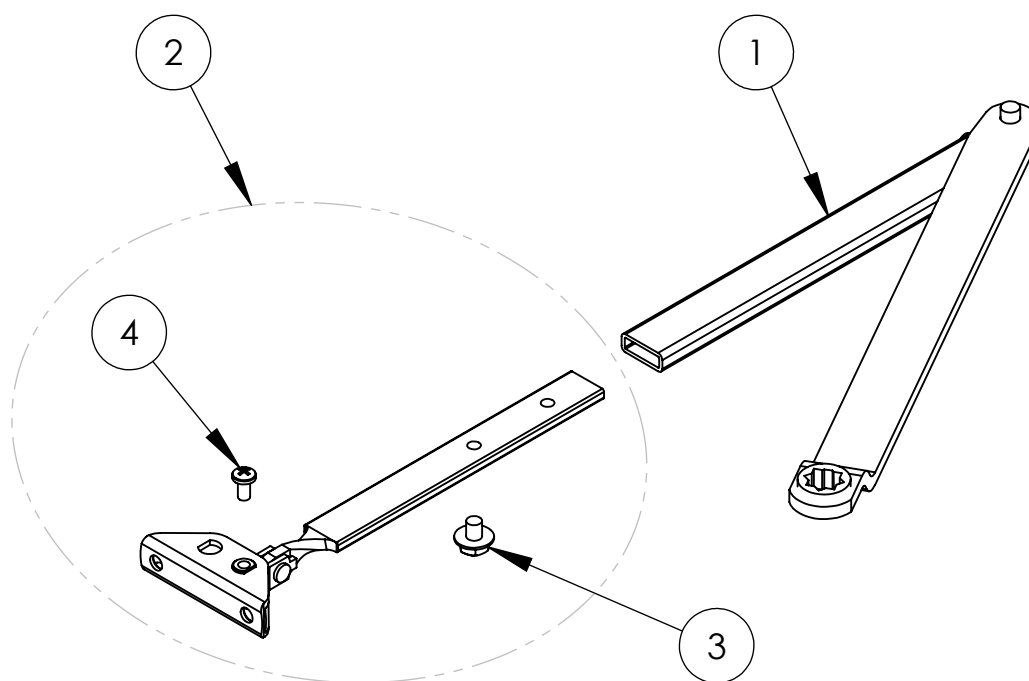

\* FINISH REQUIRED: POWDER COAT FINISHES - EB, EN, ED, EP, EAP.

© SARGENT Manufacturing Company. An ASSA ABLOY Group Company. All Rights reserved.

**SARGENT®**  
**ASSA ABLOY**