

FALCON®

Medium
duty

Commercial pushpads



Trim designs

Control trim

SP28, SP313 and US-32D.

K-control



911K
BE
NL

L-control



L-Control-Dane
912L
BE
L-DT
NL



L-Control-Sutro
912L
BE
L-DT
NL



L-Control-Quantum
912L
BE
L-DT
NL

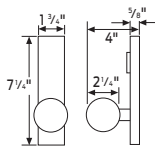

Key locks or unlocks trim. Knob retracts trim. Knob retracts latchbolt when trim is unlocked.

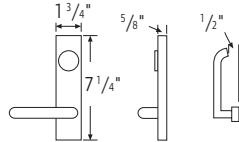

Lever Projection: Quantum = 3"
Sutro = 2 7/8"
Dane = 2 7/8"

Key locks or unlocks trim. Lever retracts latchbolt when trim is unlocked. Dane, Quantum and Sutro levers return to within 1/2" of door.

DT-control



918 DT
Pull when dogged.

NL-control



918NL
Key retracts latchbolt.

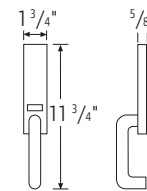

9970
Can be used with all devices (not for use on wood doors).

9 1/4" center to center

2 7/8" projection

1 3/4" clearance

Cover plates



4167
3 1/4" x 15" x .050
Used with TP control & DT control
Covers 161 & 86 cutouts



4168
3 1/4" x 7 1/2" x .050
Used with EO device to cover No. 86 cutout for mortise lock



4170
3 1/4" x 7 1/2" x .050
Used with K control, DT/K control, L control, or DT/L control
Covers 161 & 86 cutouts

Key-in-lever



914KIL



914-KIL-IC

For 1-3/4" thick doors only

Centron trim

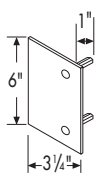

930 EO

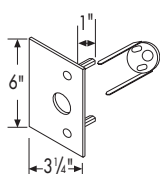

930 C

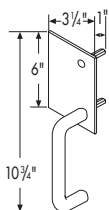

930 DT

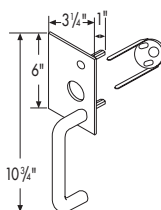

930 NL



Pull only 917 DT
CTC - 5 1/2" round - 3/4" dia.
Pull when dogged.

Trident trim

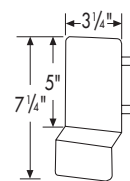

920 DT

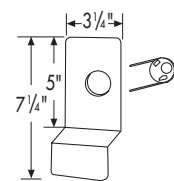

920 NL

Strikes

1690 Concealed vertical rod device



PB48
Top strike for 1690 device. Packed with three 0.050" thick shims. 1 1/16" x 1 1/16" x 7/16" (H x W x D)

1790 Rim device



STK45
Strike for inactive leaf, pair of doors with 1790 device. 3 1/4" x 1 5/16" x 1/4" (H x W x D)



TD35
Strike for single doors, 1790 device. Includes 1/8" shim. 3" x 2" x 1/2" (H x W x D)

(F) 19-R Rim devices



F570
Standard strike. 2 5/8" x 1 1/4" x 13/16" (H x W x D)



F490
Optional strike. 2 5/8" x 1 1/4" x 7/8" (H x W x D)



565
Adjustable surface mounted for use with blade or applied stops. Mounts flush for 1/2" stop height.



571/571A
Used on inactive leaf for device on active leaf of pair of doors without removable mullion. 571 keeps 2 5/16" backset. 571A is trimmer and projects less into opening.

(F) 19-V Surface vertical rod devices



3788
Top strike for 19-V.



2130
19-V bottom strike for grouting into concrete or masonry floors.



4155
19-V optional bottom strike.



2126A
19-V optional bottom strike.

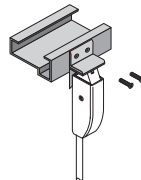

4215
Angle bracket for 19-V devices flush transom applications. Does not require elimination of latch retention feature.



Extension rods
Extension rods are available in 12", 24" and 36" lengths in all finishes. Both ends tapped and all-thread included as connector.

Accessories

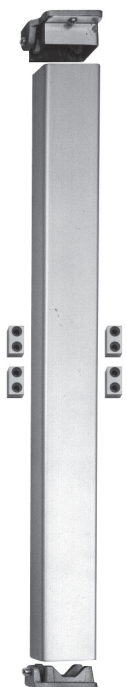

F-4023 Shown

Removable mullion

- Removable mullions are easily removed and reinstalled for full width access
- Increased security and tighter closure
- Minimizes door warp age and sag
- Regulates the traffic flow in-and-out
- Rim devices are used on both leaves, attaining a perfect symmetrical opening
- Mullion assembly consists of a mullion, top and bottom fittings and mounting package
- Mullion can be cut on the job for doors under stock lengths

2923, (F)4023, (F)KR4023 Mullion

These steel mullions can be used with the 19-R and F-19-R devices. Soffit adapters are available for the 2923 and 4023 mullions. The F4023 and F-KR4023 fire-rated mullions also include four stabilizer blocks as required for labeled installations. Strikes are not included with mullion and should be specified with the 19-R or F-19-R device, see page 11 for strike information. KR mullions require 1 1/4" mortise cylinder with standard "A" cam. The mullion fittings are made from ductile iron. The (F)4023 and (F)KR4023 are 2" wide and 3" deep. The 2923 is 1 1/2" wide and 2 1/2" deep. Furnished in prime coat.

Mullions



RM 170

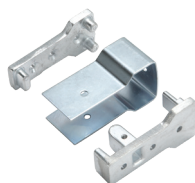

Mullion brackets



525 Mullion stabilizer for RM170

RM 170 Removable mullion

RM 170 for use with 1790 series. Comes complete with adjustable mortised strikes and security clips. Compatible with doors 7' to 10' and for use with stiles as narrow as 1 3/4". Made of aluminum, available in anodized aluminum or bronze finishes. Mullion is 3 1/2" deep, 1" wide on door side, and 1 5/8" at the widest point.

Mullion strikes



STK170

Adjustable mortise strikes (pair).

- 2 7/8" tall
- 1 3/4" wide
- 1" thick

Sex bolts

Sex bolts are available for 1 3/4" door thickness. Screws to fit are available in 3/4" and 2" lengths to cover a wide range of door thicknesses.

2729 (#10-24 thread)

4122 (1/4"-20 thread)

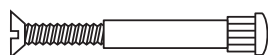

Filler plates

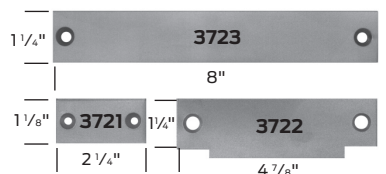

3721/3722/3723

Steel filler plates

- 3721 Cylindrical lock frontfiller
- 3722 ASA strike filler - set no. SC for 161 cutout
- 3723 Mortise lock front filler
- 3722 ASA strike filler - set no. SM for 86 cutout

Accessories

Popular EL application

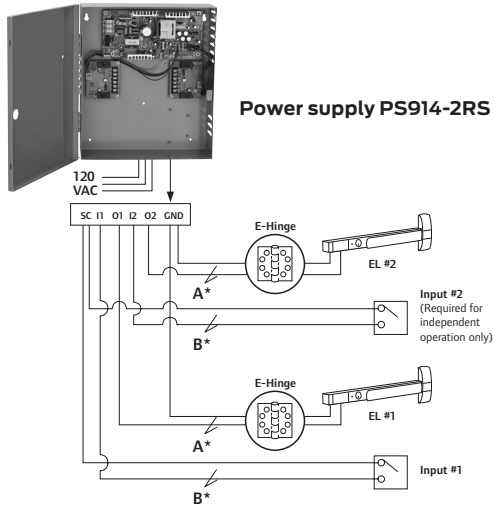

EL Device wire selection size

A*	Run length	EL device w/EPT or door loop
	0-100 ft.	14 gauge
	100-200 ft.	12 gauge

A*	Run length	EL device w/electric hinge/pivot
	0-75 ft.	14 gauge
	76-150 ft.	12 gauge

B*	Wire selection	Switch wire size
	1200 ft. max.	18 gauge